

# TECHNOLOGY IN MOTION



**INDUSTRIAL**



**POWER GEN**



**WIND ENERGY**

## SMT series

Dry & submersible screw pumps  
for industrial applications - 80 bar pressure



## Three screw pumps

Three screw pumps represent the largest class of multiple screw pumps in service today. No matter the applications and the environmental conditions, three screw pump is the most flexible pump on the market.

Well known to be very reliable, at reasonable cost, virtually pulsation-free flow, very low acoustic emissions, three screw pumps are extensively used in meeting the requirements of oil & gas, chemical, marine, industrial, mobile, alternative energy, food processing, paper, power gen, pharmaceutical and many other industries.

**SMT** three screw pumps represent one of the most used pump series all over the world after thirty five years of experience.

### **Le pompe a tre viti**

*Le pompe a tre viti, oggi, rappresentano la classe di pompe a viti maggiormente utilizzate, indipendentemente dal tipo di applicazione e dalle condizioni ambientali, in quanto sono le più flessibili sul mercato. Sono considerate le più affidabili, a prezzi ragionevoli, e raggiungono bassissimi livelli di emissioni acustiche e assenza di vibrazioni nella trasmissione del flusso. Le pompe a tre viti sono ampiamente utilizzate in quanto rispettano i requisiti di settori quali oil & gas, chimico, navale, mobile, agroalimentare, power generation ed energie alternative, industria della carta, industria farmaceutica e molte altre.*

*Le pompe a tre viti della serie **SMT**, sono tra le più usate in tutto il mondo e vantano oltre trent'anni di esperienza.*

## No pulsation – smooth flow. Low noise

**SMT** three screw pumps are designed to avoid any pulsation, to ensure a smooth operation and to reduce to the lowest level the acoustic emissions reducing all costs of second noise reduction measures.

The pulsation-free flow of **SMT** pumps allows Settima screw pumps also in output condition management critical to applications such as precision hydraulic controls and fuel metering.

### **Flusso omogeneo – Nessuna pulsazione. Basse emissioni acustiche**

*Le pompe a tre viti della serie **SMT** sono progettate per eliminare le pulsazioni, assicurare un funzionamento omogeneo e ridurre al minimo le emissioni acustiche, riducendo in questo modo i costi legati alla necessità di ricorrere a misure secondarie per la riduzione del rumore.*

*Il flusso privo di pulsazioni delle pompe **SMT**, permette l'applicazione delle pompe Settima anche in condizioni critiche, come ad esempio idraulico di precisione, dosaggio e misurazione di carburanti.*

## SMT Magnetic coupling

**SMT** pump can be equipped with a magnetic coupling if required. The hermetically sealed magnetic coupling is a permanent magnetic synchronous coupling able to transmit torque through magnetic forces between the internal and external rotor. Applying a magnetic coupling, the drive and the driven sides are hermetically separated. In case of critical media the magnetic coupling is a reliable seal and avoids any serious leaking.

The magnetic coupling is the containment shroud that is fixed to the driven sided power unit and separates internal and external rotor from each other. Due to the absence of mechanical connection the vibrations torque transmission are very low, with completely leak-proof separation of product and atmosphere.

The magnetic coupling is used to ensure no media leaking or when working in environments with potentially explosive atmospheres.

### **SMT Giunto magnetico**

*Le pompe **SMT** possono, su richiesta, essere dotate di giunto magnetico. Il giunto magnetico permette di sigillare l'accoppiamento che trasmette la coppia tra il rotore interno ed esterno tramite forza magnetica. Con l'applicazione del giunto magnetico, l'elemento di trasmissione e quello condotto sono ermeticamente separati. In caso di fluidi pericolosi, il giunto magnetico garantisce una tenuta a media che impedisce perdite. Il giunto magnetico consiste nella copertura fissata sull'elemento condotto che separa il rotore interno da quello esterno. Grazie all'assenza di connessioni meccaniche, le vibrazioni dovute alla trasmissione di potenza sono molto ridotte, senza possibilità di contaminazione dell'atmosfera da parte del fluido e viceversa. Il giunto magnetico è utilizzato per prevenire in modo sicuro perdite in ambienti con atmosfera potenzialmente esplosiva.*

## Technical characteristics / Caratteristiche tecniche

Types Tipi	Dry (SMT) or submersed (SMIT) Esterno (SMT) o immerso (SMIT)	
Models Modelli	20 - 25 - 32 - 40 - 45 - 55 - 60 - 70 - 80 - 90	
Installation Installazione	Free for SMT. Submerged (totally or partially) for SMIT Qualsiasi per SMT. Sommerso (parzialmente o completamente) per SMIT	
Flanges Flange	ISO 3019/2	
Connections Connessioni	SAE 3000 - BSPP	
Drive (loading) Carichi	No axial or radial loads Nessun carico assiale o trasversale	
Shaft rotation Rotazione albero	Clockwise (from shaft end), (suitable also for counter clockwise rotation) Destra (risponibile anche per rotazione sinistra)	
Shaft speed Velocità di rotazione	From 500 to 3.600 rpm <sup>(1)</sup> Da 500 a 3.600 rpm <sup>(1)</sup>	
Flows Portate	From 4 up to 1.220 L/min Da 4 a 1.220 L/min	
Outlet Pressure Pressione di mandata	Up to 80 bar Fino a 80 bar	
Inlet Pressure Pressione in aspirazione	Min. -0.7 bar max. 3 bar <sup>(2)</sup> Min. -0.7 bar max. 3 bar <sup>(2)</sup>	
Fluids <sup>(3)</sup> Fluidi <sup>(3)</sup>	<ul style="list-style-type: none"> <li>• Mineral oil HLP e HLVP</li> <li>• Ecologic fluid: HETG, HEPG, HEE</li> <li>• Synthetic fluid or emulsion: HFA oil-water emulsion, HFB water-oil emulsion 40% of volume, HFC water-glycol-water max 35 to 55%, HFDR phosphate ester</li> <li>• Lubrication high viscosity oils</li> <li>• Special synthetic fluid: MIL-H, SKYDROL</li> <li>• Fuel oil: MGO, MDO, Low sulfur MDO and HFO</li> <li>• DMX (ISO8217), DMA, DMB, DMC, DMZ</li> <li>• Bunker oil, furnace oil, engine oil, heating oil, hydraulics oils DIN 51524</li> </ul>	<ul style="list-style-type: none"> <li>• Oil, mineral HLP e HLVP</li> <li>• Fluidi ecologici HETG, HEPG, HEE</li> <li>• Fluidi sintetici o emulsioni: HFA emulsione olio-acqua, HFB emulsione acqua-olio 40% di volume, HFC acqua/glicole-acqua max 35 to 55%, HFDR phosphate ester</li> <li>• Olio ad alta viscosità per lubrificazione</li> <li>• Fluidi speciali sintetici: MIL-H, SKYDROL</li> <li>• Fuel oil: MGO, MDO, Basso livello di zolfo MDO e HFO</li> <li>• DMX (ISO8217), DMA, DMB, DMC, DMZ</li> <li>• Bunker oil, furnace oil, olio per motori, heating oil, olio idraulico DIN 51524</li> </ul>
Viscosity Viscosità	From 2 up to 10.000 cSt <sup>(4)</sup> Da 2 fino a 10.000 cSt <sup>(4)</sup>	
Seals Guarnizioni	NBR, FKM, EPDM <sup>(5)</sup>	
Acoustic Emissions Emissioni Acustiche	From 52 up to 68 db(A) at 2.950 rpm (value based on ISO 4412 test procedure) Da 52 fino a 68 db(A) a 2.950 rpm (ISO 4412 test)	
Pump body Corpo pompa	Extruded aluminum alloy Alluminio estruso	
Pump body (special applications) Corpo pompa (applicazioni speciali)	Cast iron, steel. Hardened steel and stainless steel available on request. Ghisa, acciaio. Acciaio temprato e acciaio inossidabile su richiesta.	
Screws Viti	Steel for main screw, idler cast iron Acciaio vite principale, ghisa viti secondarie	
Screws (special applications) Viti (applicazioni speciali)	Case hardened steel screws, surface treated screws Viti in acciaio temprato, viti trattate superficialmente	
Environment temperature Temperatura ambiente	From -50° up to +60°C Da -50° a +60°C	
Hydraulic Temperature Temperatura olio	From -50°C up to +300°C Da -50°C a +300°C	
Filtration Filtrazione	Permissible degree of fluid contamination NAS to 1638 class 10 or ISO/DIS 4406 - 19/16. Recommended filtration $\beta_{25} \geq 25$ Contaminazione NAS tipo 1638 classe 10 o ISO/DIS 4406 - 19/16. Filtrazione raccomandata $\beta_{25} \geq 25$	

All data reported by catalogue can change without any notice. I dati presenti nel catalogo possono cambiare senza preavviso.

(1) For shaft speed lower than 1.000 rpm and over 1.800 rpm please contact Settima. Per velocità inferiori a 1.000 rpm e maggiori di 1.800 rpm contattare Settima.

(2) For higher pressure please contact Settima. Per pressioni maggiori contattare Settima.

(3) For request of different fluids please contact Settima. Per l'utilizzo di diversi fluidi contattare Settima.

(4) For level of viscosity lower than 20 cSt and over 320 cSt please contact Settima. Per i livelli di viscosità inferiori a 20 cSt e superiori a 320 cSt contattare Settima.

(5) For special seals, contact Settima. Per le vite speciali, contattare Settima.

## DIFFERENT COMBINATIONS OF SMT PUMP / DIFFERENTI COMBINAZIONI DELLA POMPA SMT

Flange configurations view / Configurazioni flangia

A

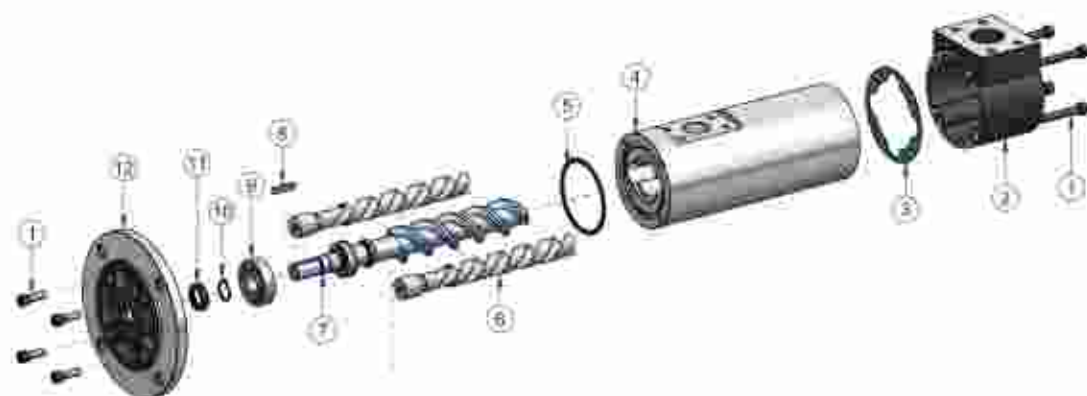

B



C



D



N°	Parts description / Descrizione componenti	Material / Materiale
1	Screw / Vite	Common components
2	Radial suction cover / Tappa radiale	Common components
3	Plane gasket / Guarnizione piano	Common components
4	Pump body / Corpo pompa	Common components
5	O-ring / Anello O-ring	Common components
6	Idler screw / Vite laterale	Common components
<b>SMT (A)</b>		
7	Main screw / Vite centrale	Common components
8	Key / Linguetta	Common components
9	Ball bearing / Cuscinetto	Common components
10	Seeger	Common components
11	Seal / Anello di tenuta	Common components
12	Flange / Flangia	Common components
1	Screw / Vite	Common components
<b>SMT MECHANICAL SEAL (B) / SMT TENUTA MECCANICA (B)</b>		
7	Main screw / Vite centrale	Common components
8	Key / Linguetta	Common components
9	Ball bearing / Cuscinetto	Common components
10	Seeger	Common components
13	Mechanical seal / Tenuta meccanica	Common components
14	Driving oil bushing / Boccata convergenza olio	Common components
12	Flange / Flangia	Common components
1	Screw / Vite	Common components
<b>SMT HOLLOW SHAFT (C) / SMT ALBERO CAVO (C)</b>		
7	Main screw / Vite centrale	Common components
9	Ball bearing / Cuscinetto	Common components
10	Seeger	Common components
11	Seal / Anello di tenuta	Common components
12	Flange / Flangia anteriore	Common components
1	Screw / Vite	Common components
<b>SMT MAGNETIC COUPLING (D) / SMT GIUNTO MAGNETICO (D)</b>		
7	Main Screw / Vite centrale	Common components
8	Key / Linguetta	Common components
9	Ball bearing / Cuscinetto	Common components
10	Seeger	Common components
12	Flange / Flangia anteriore	Common components
1	Screw / Vite	Common components
5	O-ring / Anello O-ring	Common components
15	Internal rotor MC / Rotore interno MC	Common components
16	Containment shroud MC / Cappuccio MC	Common components
1	Screw / Vite	Common components
17	External rotor MC / Rotore esterno MC	Common components

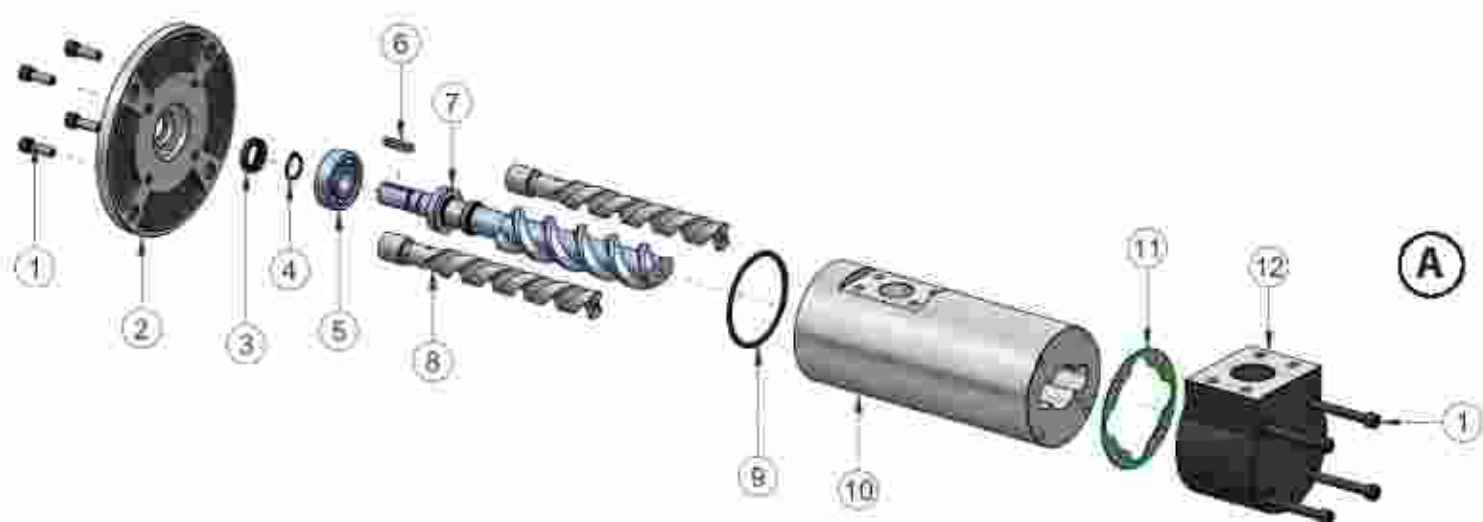

Suction configurations view / Configurazioni aspirazione pompa

N°	DESCRIPTION / DESCRIZIONE	MATERIAL* / MATERIALE*
1	Screw / Vite	Common components
2	Flange / Flangia anteriore	Common components
3	Seal / Anello di tenuta	Common components
4	Seeger	Common components
5	Ball bearing / Cuscinetto	Common components
6	Key / Linguetta	Common components
7	Main screw / Vite centrale	Common components
8	Idler screw / Vite laterale	Common components
9	O-ring / Anello O-ring	Common components
10	Pump body / Corpo pompa	Common components
11	Plane gasket / Guarnizione plana	Common components
<b>SMT (A)</b>		
12	Radial suction cover / Tappo radiale	Common components
1	Screw / Vite	Common components
<b>SMT AX (AXIAL BSPP) (B) / SMT AX (ASSIALE BSPP) (B)</b>		
1	Screw / Vite	Common components
12	Axial suction cover / Tappo assiale	Common components
<b>SMT AL (TOP FLANGE FOR VERTICAL INSTALLATION OVER TANK) (C) SMT AL (TAPPA ASPIRAZIONE PER INSTALLAZIONE VERTICALE SOPRA SERBATOIO) (C)</b>		
1	Screw / Vite	Common components
12	Tank top flange / Tappa aspirazione sopra serbatoio	Common components
<b>SMT SUBMERSIBLE (D) / SMT SOMMERSA (D)</b>		
12	Filter / Filtro	Common components
13	Clamp / Fascetta	Common components

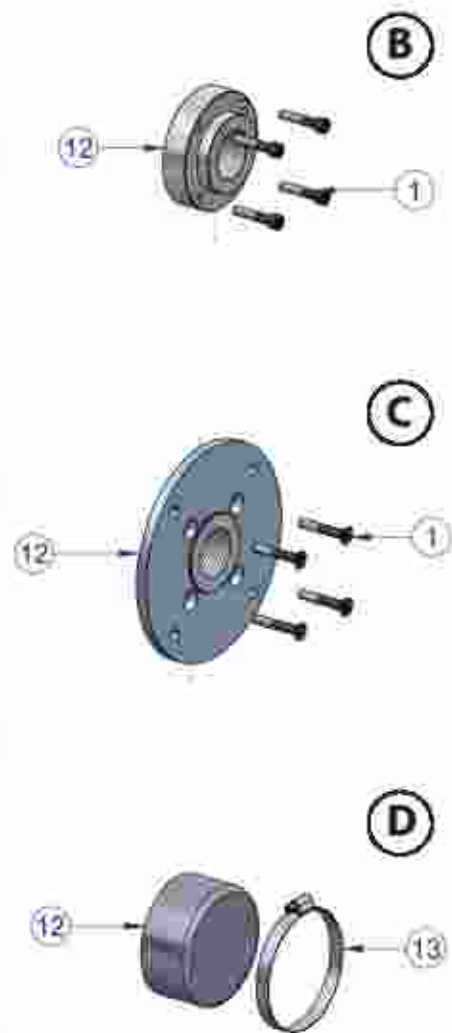

All data reported by catalogue can change without any notice. I dati presenti nel catalogo possono cambiare senza preavviso.

\* Other materials available upon request. Altri materiali disponibili su richiesta.

## INDUSTRIAL LUBE SERVICES

Power hydraulics (presses, machine tools, working machines, rolling mill, dumping equipment, elevators, variable pitch propellers, hydraulic winches)

Power unit & mini power packs

Injection molding machinery (cooling & filtration systems)

Hydraulic governors

Cooling, heating, recycling

Driving and filtering

Process technology and chemistry

High pressure coolant fuel oil handling

Filtration applications

Chip conveyors

Turbine lubrication and oil jacking

Hydro power (turbines & compressor lubrication power)

Paper & Pulp (lubrication & filtration)

Gear box lube and filtration system (high viscosity lube, air emulsion, heavy duty applications)



## POWER GENERATION

Lube oil service

Control oil service

Turbine shaft jacking service

Sealing oil service for gas turbine

Fuel unloading station

Fuel transfer

Fuel feeding

Burner operations service

Filtration & cooling



## MARINE

Off-line filtration

Off-line filtration cart and trolleys

Filtration & oil transfer

Fuel service

Lube oil circulation service

Lubricating liquids (machines, turbines, gear sets, motors)



## WIND MILLS

Cooling systems

Hydraulic pitch control and yaw control

Forced lubrication systems



## OIL & GAS

Oil filtration & cooling, oil and fuel oil lubrication

Oil rigs, refineries (transport, meter and mix), off-shore platform

Petrochemical industry, transfer service



SMT Pump



SMT Series / Serie SMT  
Dry screw pump  
Pompa per uso esterno

SMIT Pump



SMIT Series / Serie SMIT  
Submersible screw pump  
Pompa per uso sommerso

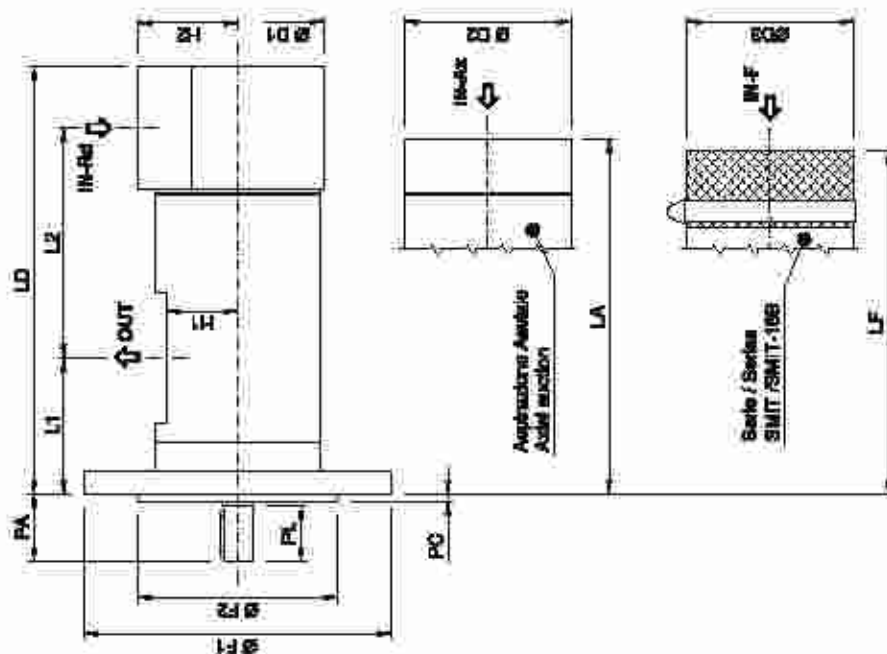
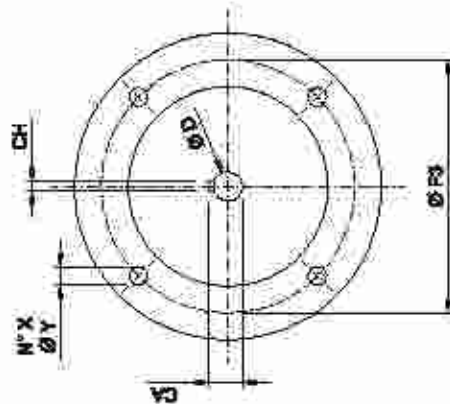



SMT Series/ Serie SMT  
Submersible screw pump  
Pompa per uso sommerso

SMT Series/ Serie SMT

Dry screw pump / Pompa per uso esterno

Type/ Tipo	Flange / Flangia			Shaft / Albero			Suction / Aspirazione		Discharge / Mandata		Pump / Pompa								
	ØF2	ØV	ØF1	ØD	CA	CH	IN-Ød	IN-Ax	H2	OUT	H1	PA	ØD2	L1	L2	LA	Ng	Pump / Pompa	
GR20 SMT 8L-12L-15L-20L- 25L	80.0	11.0	103.0	14.0	16.0	5.0	1/2" BSPP	1/2" BSPP	26.0	1/2" BSPP	25.0	37.0	59.0	118.5	174.0	1.5	80.0	LF	
GR25 SMT 25L-30L	80.0	11.0	107.0	19.0	21.5	6.0	3/8" BSPP	3/8" BSPP	27.0	1/2" BSPP	27.5	42.0	65.0	171.0	262.0	4	66.0	242.5	
GR32 SMT 35L-45L-55L- 75L	100.0	11.0	125.0	19.0	21.5	6.0	1" NPT SAE-3000	1" NPT BSPP	55.0	1" SAE- 3000	41.0	41.0	94.0	69.0	192.0	248.0	6.5	95.0	299.0
GR40 SMT 100L-125L-150L	125.0	14.0	160.0	19.0	21.5	6.0	1" NPT SAE-3000	1" NPT BSPP	65.0	1" SAE- 3000	46.5	39.5	108.0	84.5	224.5	302.0	10.8	109.0	294.0
GR45 SMT 180L-210L	125.0	14.0	160.0	32.0	35.0	10.0	2" SAE- 3000	2" BSPP	85.0	2" SAE- 3000	51.5	64.5	122.5	89.0	248.0	330.0	15	123.5	312.0
GR55 SMT 250L-300L- 330L-380L	160.0	18.0	200.0	32.0	35.0	10.0	2" NPT SAE-3000	2" BSPP	95.0	2" SAE- 3000	55.0	61.5	142.5	100.5	297.0	388.5	21.5	143.5	395.5
GR60 SMT 440L-500L	180.0	18.0	200.0	32.0	35.0	10.0	3" SAE- 3000	3" BSPP	105.0	2" NPT SAE-3000	63.0	65.5	155.0	101.0	342.0	423.5	30	154.0	430.5
GR76 SMT 600L-660L-800L	200.0	22.0	250.0	32.0	35.0	10.0	3" NPT SAE-3000	3" BSPP	110.0	3" SAE- 3000	73.0	60.5	180.0	115.5	422.0	529.5	44	179.0	543.5
GR80 SMT 1,000L-1,200L	200.0	22.0	250.0	38.0	41.0	10.0	4" SAE- 3000	4" BSPP	125.0	3" SAE- 3000	83.0	75.0	210.0	150.0	470.5	644.0	59	204.0	628.0
GR90 SMT 1,200L	200.0	22.0	250.0	38.0	41.0	10.0	4" SAE- 3000	4" BSPP	125.0	3" SAE- 3000	83.0	75.0	210.0	150.0	470.5	644.0	61	204.0	628.0

All data reported by catalogue can change without any notice. / dati present nel catalogo possono cambiare senza preavviso.

SMT AC Pump



SMT AC Series / Serie SMT AC  
Dry screw pump  
Pompa per uso esterno

SMT AC Pump



SMT AC Series / Serie SMT AC  
Submersible screw pump  
Pompa per uso sommerso

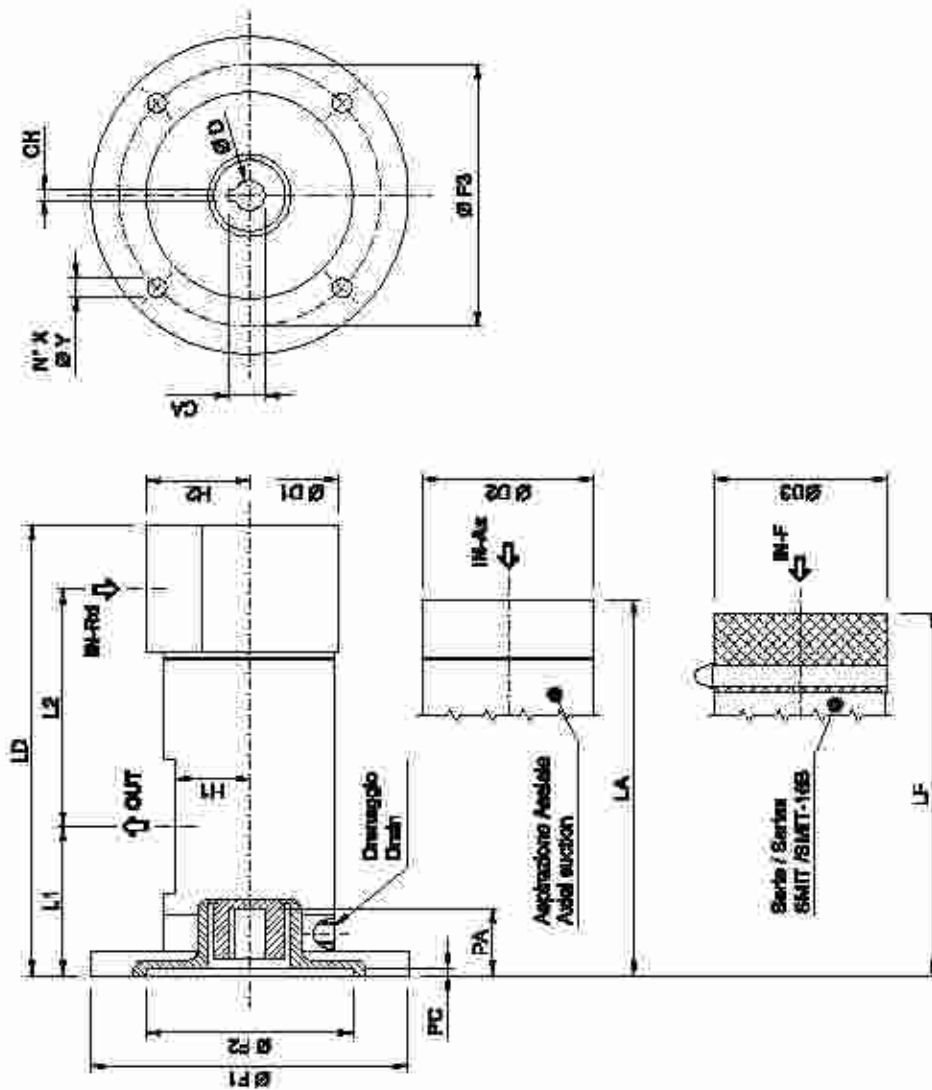

SMT AC Series/  
Serie AC SMT

Submersible screw pump/  
Pompa per uso sommerso

SMT AC Series / Serie SMT AC

Dry screw pump / Pompa per uso esterno

Type/Modello	Power/Alimentazione			S.M.T. / Alimentazione			Suction / Aspirazione			Discharge / Mandata			Pump / Pompa							
	HP2	HP	HP3	HP1	CA	CB	CH	MB	MA	MD	MBT	MT	PA	PD2	LV	L2	LA	KG	HP3	LF
GR00 SMT AC11 B3 6-12-15-20-23	85.0	8.0	110.0	140.0	12.8	4.3	4.3	1/2" BSP	1/2" BSP	26.0	1/2" BSP	32.0	23.0	55.0	37.0	116.5	120.0	1.0	60.0	1270
GR00 SMT AC14 B0 6-12-15-20-23	110.0	9.5	130.0	160.0	16.1	5.2	5.2	1/2" BSP	1/2" BSP	26.0	1/2" BSP	29.0	33.5	56.0	36.0	118.5	123.0	1.0	60.0	1360
GR00 SMT AC19 B3 6-12-15-20-23	130.0	11.0	165.0	200.0	19.0	6.3	6.3	1/2" BSP	1/2" BSP	26.0	1/2" BSP	29.0	40.0	56.0	35.0	116.5	150.0	1.0	60.0	1650
GR03 SMT AC14 B2 3.5-10	110.0	9.5	130.0	160.0	16.3	5.2	5.2	3/8" BSP	3/8" BSP	27.0	3/8" BSP	27.5	32.5	65.0	37.5	121.0	263.0	2.7	60.0	2425
GR02 SMT AC19 B3 3.5-10	140.0	10.5	165.0	200.0	19.0	6.5	6.5	1/2" BSP	1/2" BSP	27.0	1/2" BSP	27.5	42.5	65.0	36.0	121.0	266.0	2.7	60.0	2465
GR02 SMT AC19 B5 3.5-15-25-35	180.0	12.0	165.0	200.0	19.0	6.5	6.5	1 1/4" SAE - 4000	1 1/4" BSP	53.0	1 1/4" SAE - 4000	41.0	43.5	84.0	62.7	182.0	271.5	4.8	65.0	262.5
GR03 SMT AC24 B3 3.5-15-25-35	180.0	12.0	165.0	200.0	24.0	7.5	7.5	1 1/4" SAE - 3000	1 1/4" BSP	53.0	1 1/4" SAE - 3000	41.0	52.5	84.0	62.7	182.0	271.5	4.4	65.0	262.5
GR00 SMT AC19 B1 100-125-150	140.0	10.0	165.0	200.0	19.0	6.5	6.5	1 1/2" SAE - 4000	1 1/2" BSP	63.0	1 1/2" SAE - 4000	46.5	42.5	100.0	108.5	224.5	327.0	7	100.0	3100
GR00 SMT AC24 B2 100-125-150	180.0	12.0	165.0	200.0	24.0	7.5	7.5	1 1/2" SAE - 4000	1 1/2" BSP	63.0	1 1/2" SAE - 4000	46.5	52.5	100.0	109.5	224.5	327.0	7	100.0	310.0
GR00 SMT AC28 B5 100-125-150	180.0	14.0	215.0	250.0	28.0	8.5	8.5	1 1/2" SAE - 4000	1 1/2" BSP	63.0	1 1/2" SAE - 4000	46.5	60.0	100.0	120.0	234.5	327.5	7	100.0	326.5
GR03 SMT AC28 B2 100-150	180.0	14.0	215.0	250.0	28.0	8.5	8.5	2" SAE - 3000	2" BSP	63.0	2" SAE - 3000	51.5	60.5	122.5	130.0	246.0	361.0	7	122.5	341.0
GR03 SMT AC28 B3 150-210	230.0	15.0	265.0	300.0	38.0	10.5	10.5	2" SAE - 1000	2" BSP	63.0	2" SAE - 1000	51.5	61.0	122.5	132.5	246.0	364.5	7	132.5	366.5
GR03 SMT AC28 B3 150-210	230.0	15.0	265.0	300.0	38.0	10.5	10.5	2" SAE - 1000	2" BSP	63.0	2" SAE - 1000	51.5	61.0	122.5	132.5	246.0	364.5	7	132.5	366.5
GR03 SMT AC28 B5 210-300-330-360	380.0	14.0	215.0	250.0	28.0	8.5	8.5	2 1/2" SAE - 4000	2 1/2" BSP	63.0	2 1/2" SAE - 4000	51.5	62.5	142.5	122.5	252.0	410.5	12.5	142.5	400.5
GR03 SMT AC28 B5 210-300-330-360	380.0	14.0	215.0	250.0	28.0	8.5	8.5	2 1/2" SAE - 4000	2 1/2" BSP	63.0	2 1/2" SAE - 4000	51.5	62.5	142.5	122.5	252.0	410.5	12.5	142.5	400.5
GR00 SMT AC28 B0 440-560	180.0	14.0	215.0	230.0	27.0	8.5	8.5	1" BSP	1" BSP	30.0	1" BSP	48.0	63.0	130.0	120.0	162.0	400.5	25	134.0	453.5
GR00 SMT AC28 B3 440-560	230.0	14.0	265.0	300.0	38.0	10.5	10.5	1" BSP	1" BSP	30.0	1" BSP	48.0	63.0	130.0	120.0	162.0	400.5	25	134.0	453.5
GR00 SMT AC28 B5 000-000-000	180.0	14.0	215.0	230.0	28.0	8.5	8.5	1 1/2" SAE - 4000	1 1/2" BSP	110.0	1 1/2" SAE - 4000	48.0	63.0	130.0	120.0	162.0	400.5	30	134.0	453.5
GR00 SMT AC28 B5 000-000-000	180.0	14.0	215.0	230.0	28.0	8.5	8.5	1 1/2" SAE - 4000	1 1/2" BSP	110.0	1 1/2" SAE - 4000	48.0	63.0	130.0	120.0	162.0	400.5	30	134.0	453.5
GR00 SMT AC28 B5 000-000-000	230.0	14.0	265.0	300.0	38.0	10.5	10.5	1 1/2" SAE - 4000	1 1/2" BSP	110.0	1 1/2" SAE - 4000	48.0	63.0	130.0	120.0	162.0	400.5	30	134.0	453.5
GR00 SMT AC28 B5 000-000-000	230.0	14.0	265.0	300.0	38.0	10.5	10.5	1 1/2" SAE - 4000	1 1/2" BSP	110.0	1 1/2" SAE - 4000	48.0	63.0	130.0	120.0	162.0	400.5	30	134.0	453.5

All data reported by catalogue can change without any notice. I dati riportati nel catalogo possono cambiare senza preavviso.



Suction and drain hole configuration available as per table below (orientations relative to pressure part)

Configurazioni di porte di aspirazione, mandata e drenaggio: Vedi tabella sotto.

## Standard configuration / Configurazioni standard

Standard configuration: T1 – D2

Configurazione standard: T1 – D2

Standard configuration for pumps WITH RP VALVE: T4 – D2

Configurazione standard per pompa CON VALVOLA RP: T4 – D2

SUCTION CONFIGURATION CODES / CODICI CONFIGURAZIONE ASPIRAZIONE		DRAIN CONFIGURATION CODES / CODICI CONFIGURAZIONE DRENAGGIO	
	T1		D1
	T2		D2
	T3		D3
	T4		D4

Settima recommends that in case of request of pump with RP valve (external variable regulation valve), it is necessary to choose very carefully the suction and drain configuration. Once the external valve is built on the pump it will be not possible any change of both configurations.

Settima raccomanda di scegliere attentamente la configurazione delle porte nel caso di pompe con valvola RP (valvola regolazione variabile esterna). La valvola RP impedisce di modificare l'orientamento delle porte una volta installata sulla pompa.



## Motor pump selection / Selezione motore

Please check the table below to select the right motor.

Controllare la tabella per selezionare il motore adatto.

Size	Motor form Forma motore	56 AC9	63 AC11	71 AC14	80 AC19	90 AC24	100 AC28	112 AC28	132 AC38
GR 20	B14	✓	✓	✓	✓				
	B5		✓	✓	✓				
GR 25	B14			✓	✓				
	B5			✓	✓				
GR 32	B14				✓	✓			
	B5				✓	✓			
GR 40	B14				✓	✓	✓	✓	
	B5				✓	✓	✓	✓	
GR 45	B5						✓	✓	✓
GR 55	B5						✓	✓	✓
GR 60	B5						✓	✓	✓
GR 70	B5						✓	✓	✓

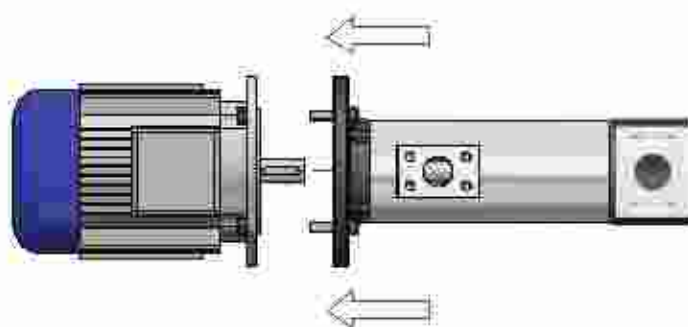
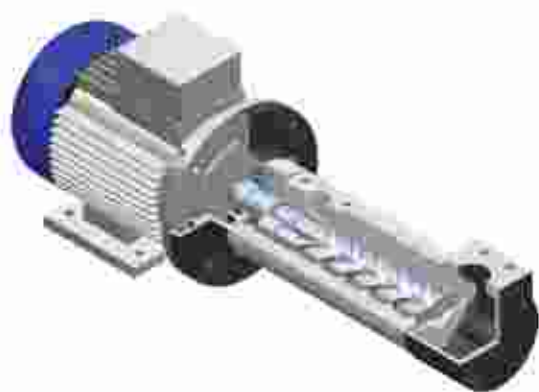

IEC standard motor



## Samples application summary / Esempi possibili per applicazioni

Fluid applications/ Applicazioni fluidi	High viscosity configuration/ Configurazione per elevate viscosità	Body material Materiale corpo	Screw material Materiale viti	Seals Tenute	Bearing type Tipo cuscinetto
Diesel fuel, marine distillate fuel, marine residual fuel, low viscosity fuel oil Diesel, distillati marini, residui marini, carburanti, fuel oil a bassa viscosità	-	G/GZ <sup>1</sup>	HA	TM	*
Heavy fuel oil transfer Trasferimento di olio combustibile	SN	G	HD	TM	*
Lube services high viscosity – gearboxes air emulsion Lubrificazione ad alta viscosità – emulsioni aria per ingranaggi	SN	*	*	*	*
Water glycolic / Emulsioni acqua-glicole	-	G/GZ <sup>1</sup>	HA	TM	CS
Machine tools – coolant systems Macchine utensili – sistemi lubrorefrigeranti	-	G	HA	TM	CS

All data reported by catalogue can change without any notice. I dati presenti nel catalogo possono cambiare senza preavviso.

<sup>1</sup> Contact Settima for high pressure applications. Contattare Settima per applicazioni ad alta pressione.

\* Standard configuration and material. Configurazione e materiali standard.

### Example of codes normal shaft / Esempi di codici albero maschio:

GR45 SMT 210L G HD TM 

### Example of codes for hollow shaft models / Esempi di codici per modelli ad albero cavo:

GR32 SMT 45L AC24/B5 G V 

# Performances @ 1500 - GR 20-25

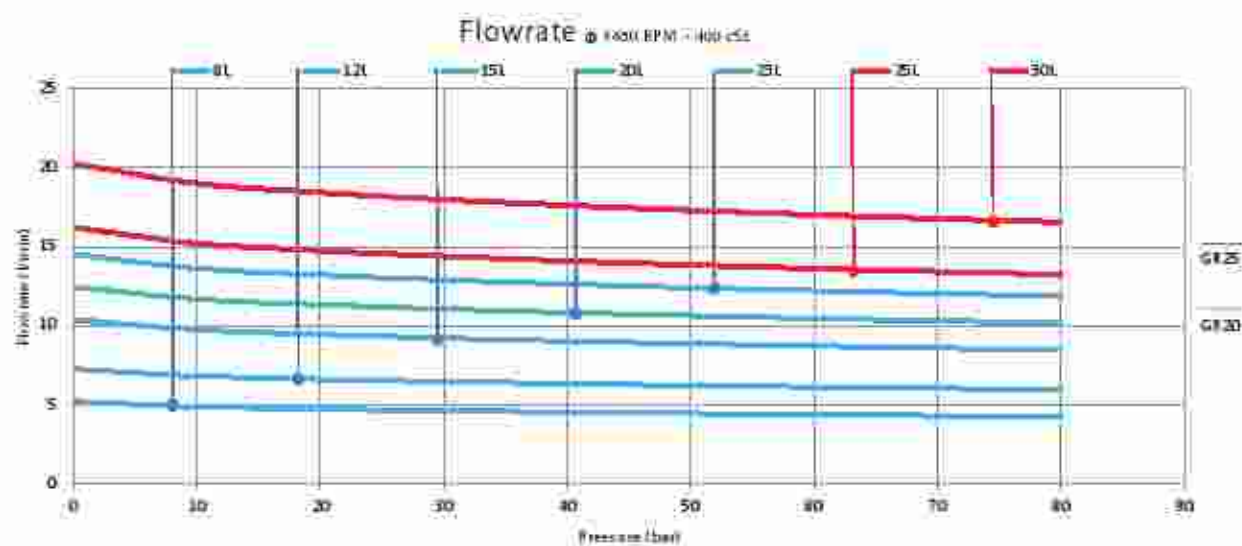
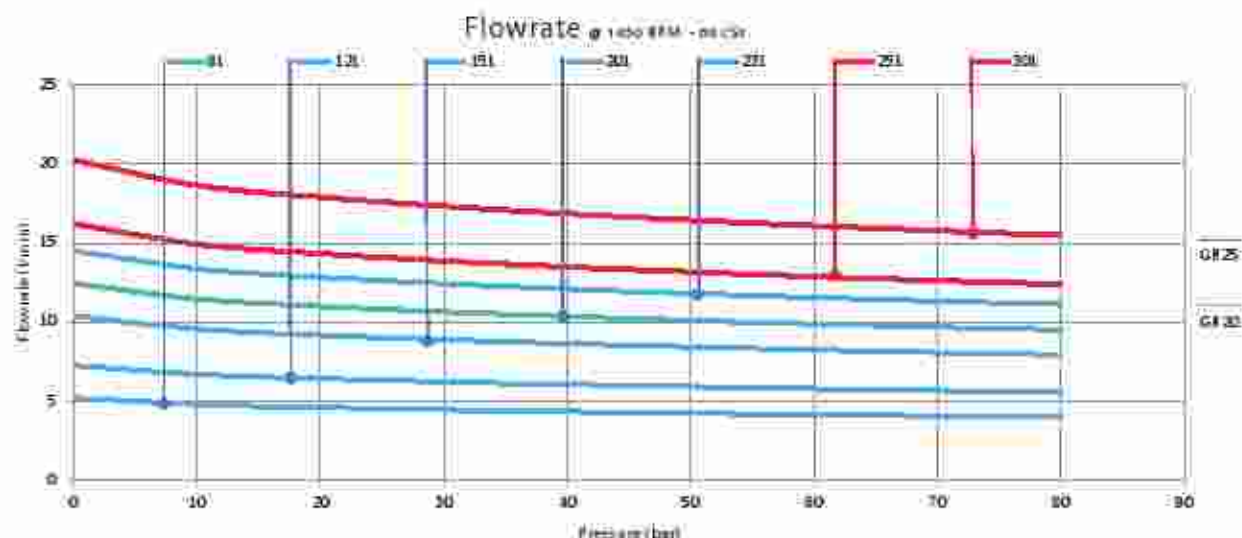
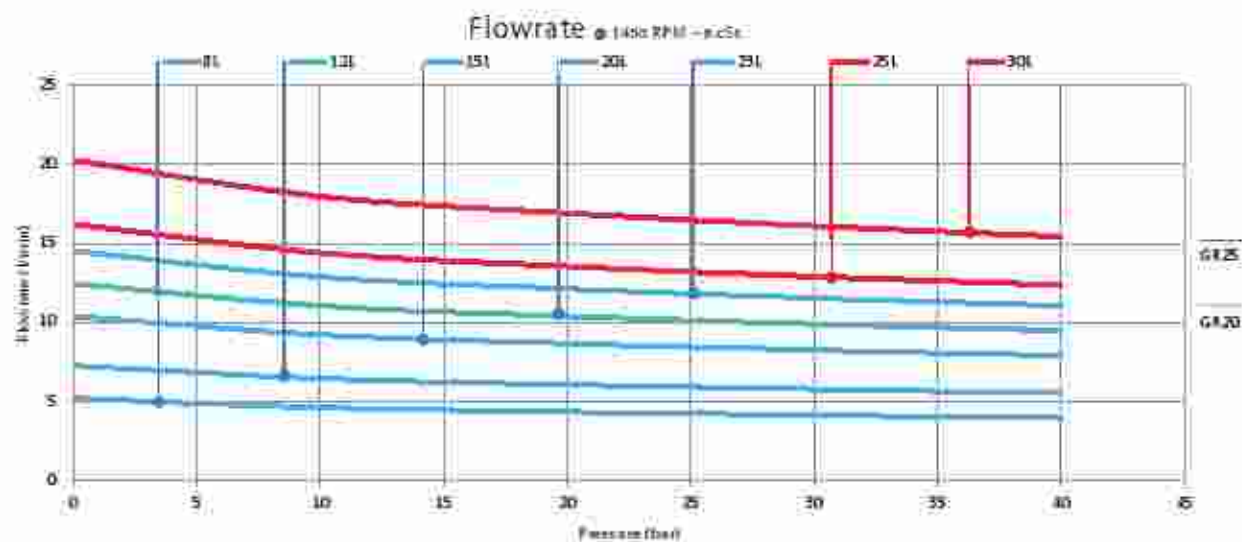



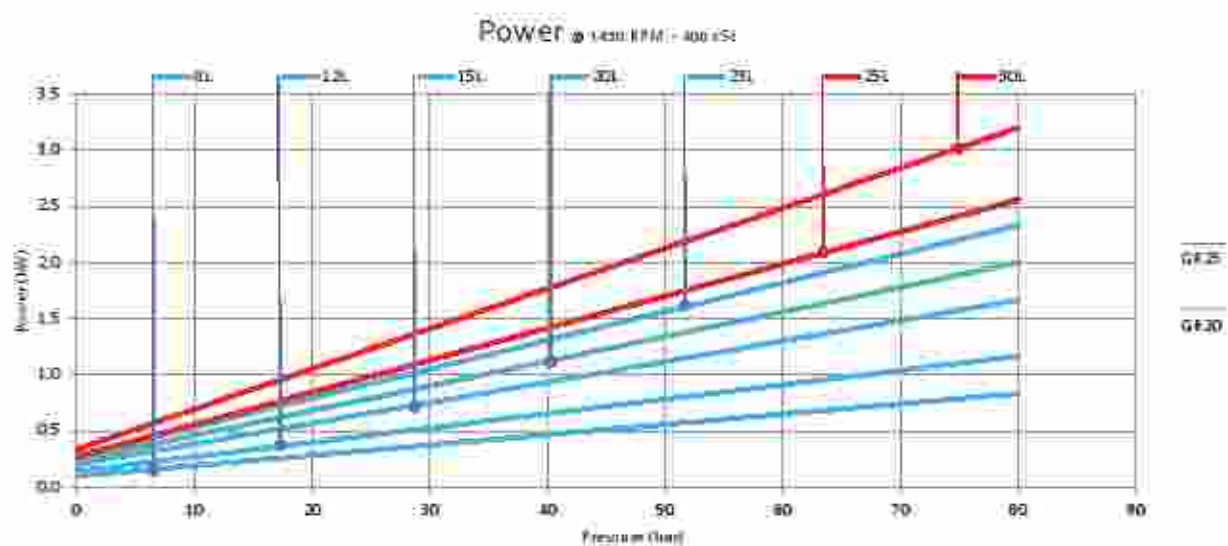
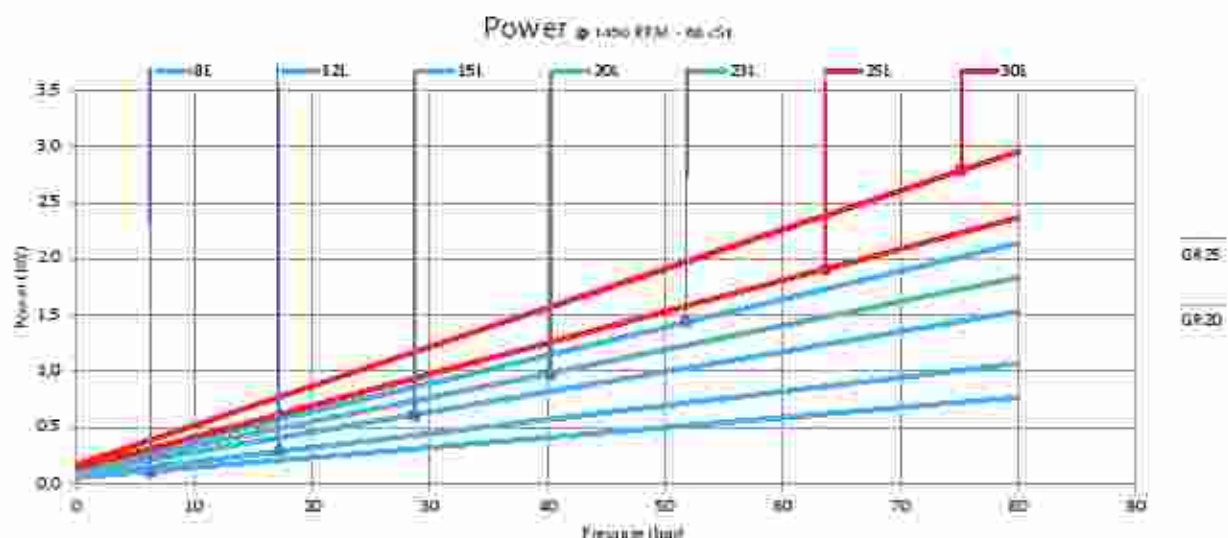
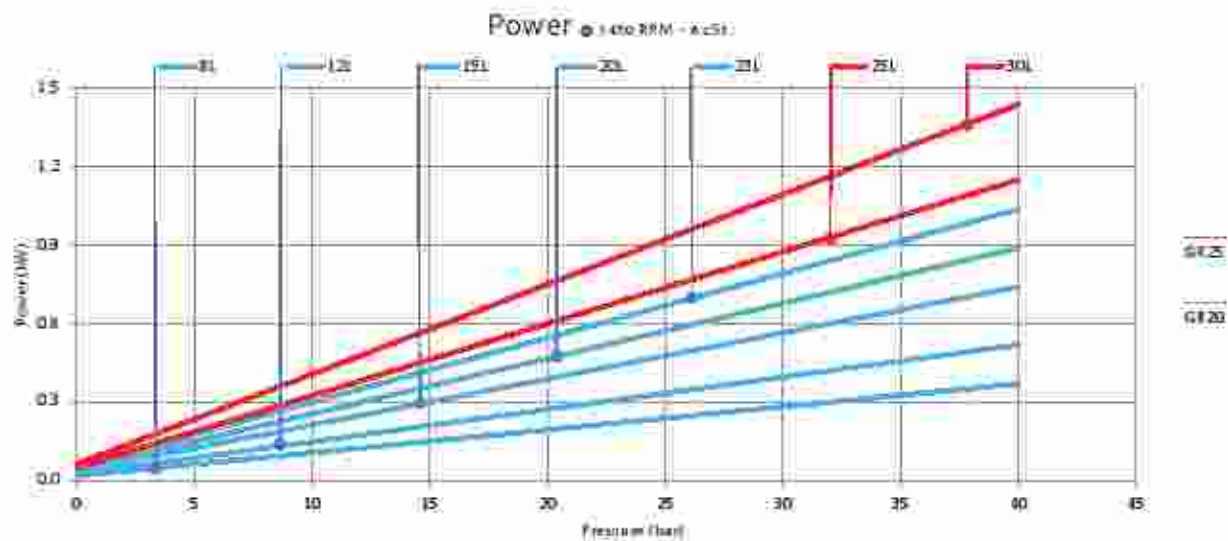

# Performances @ 3000 - GR 20-25

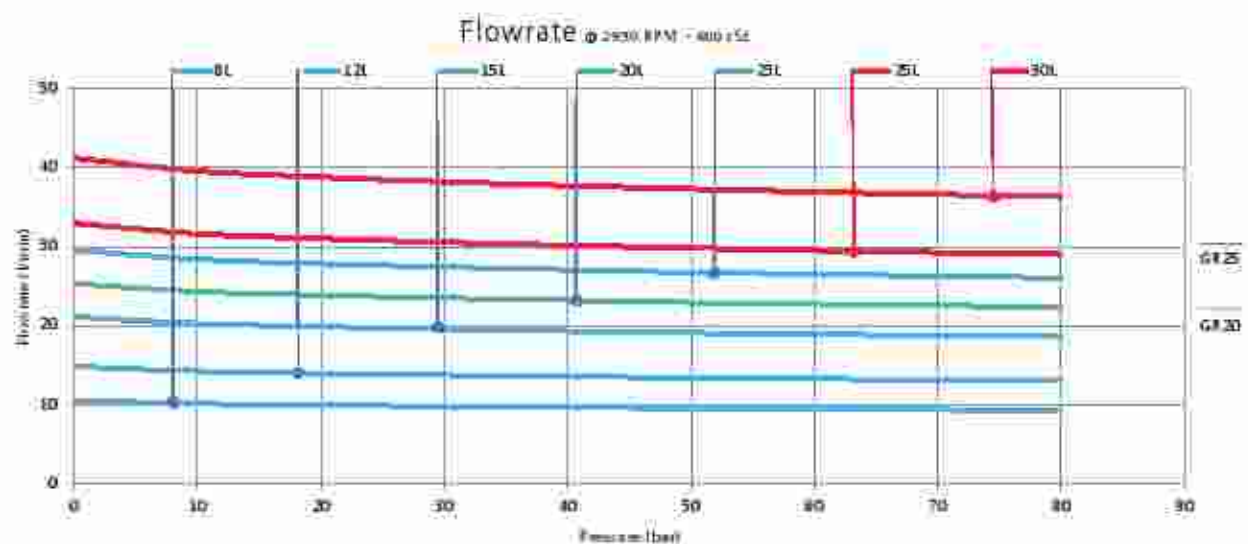
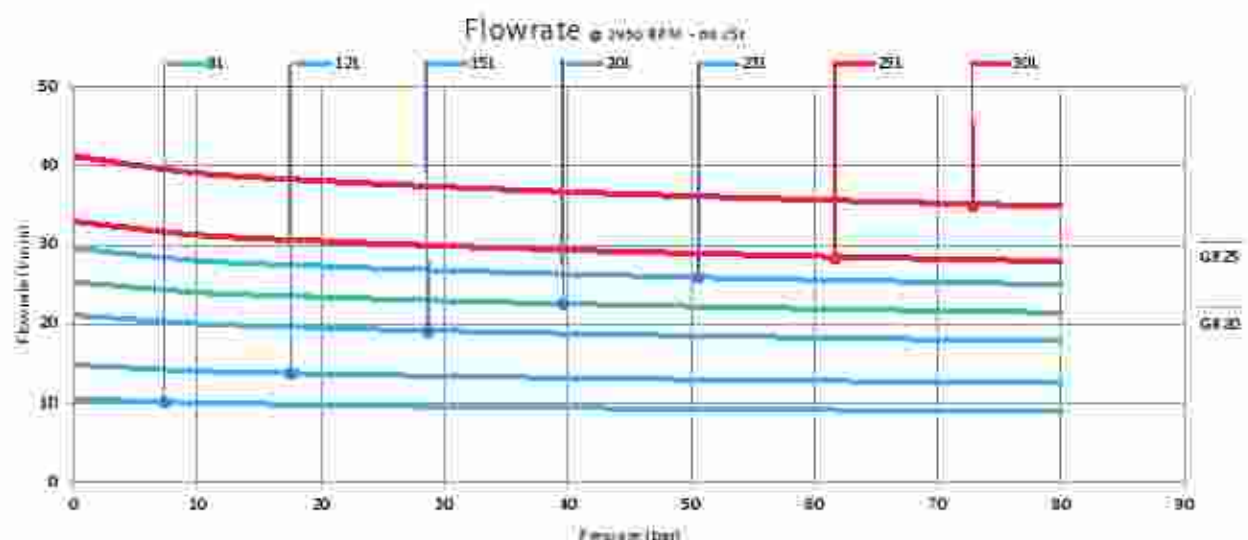
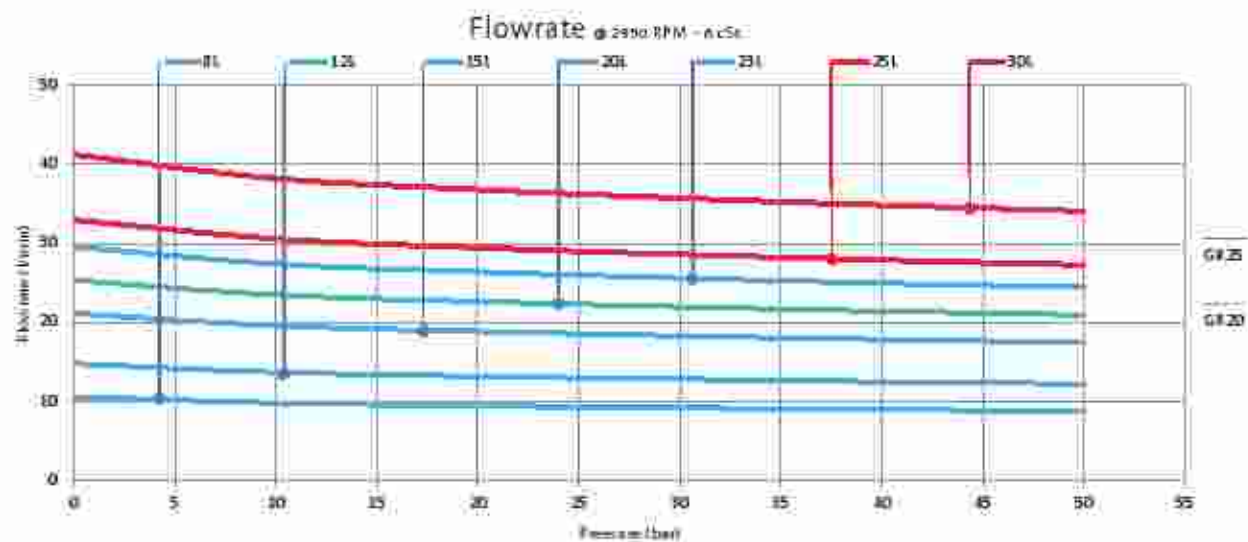

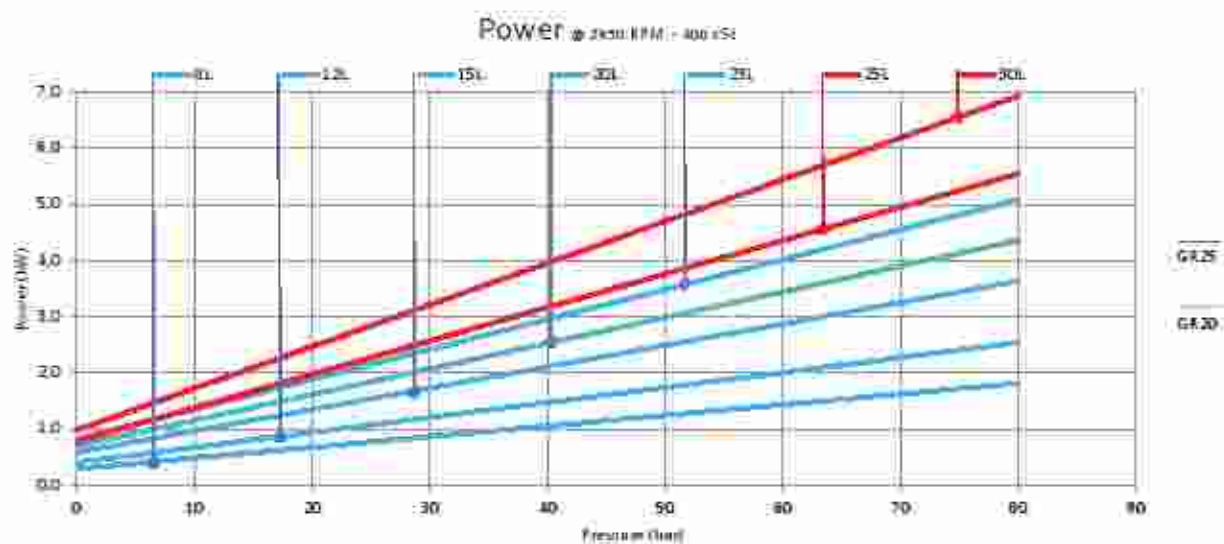
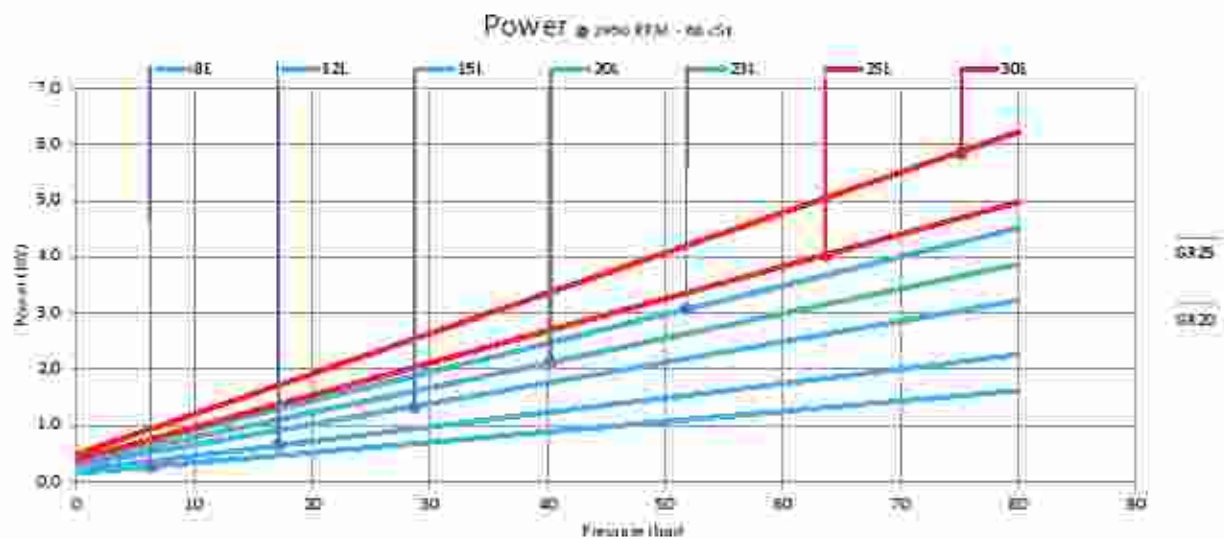
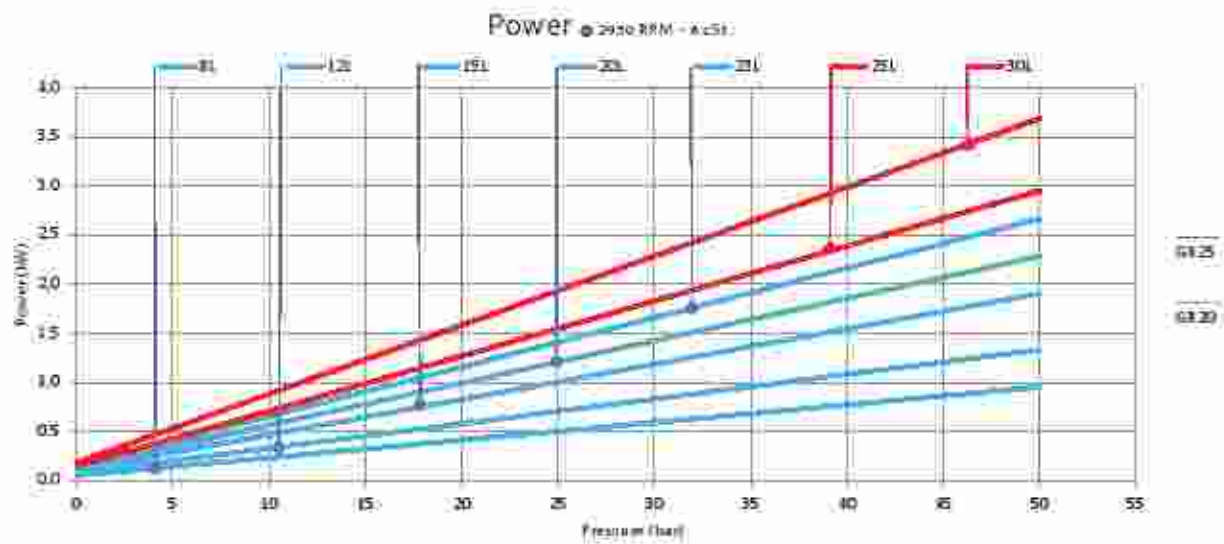

# Performances @ 1500 - GR 32-40-45

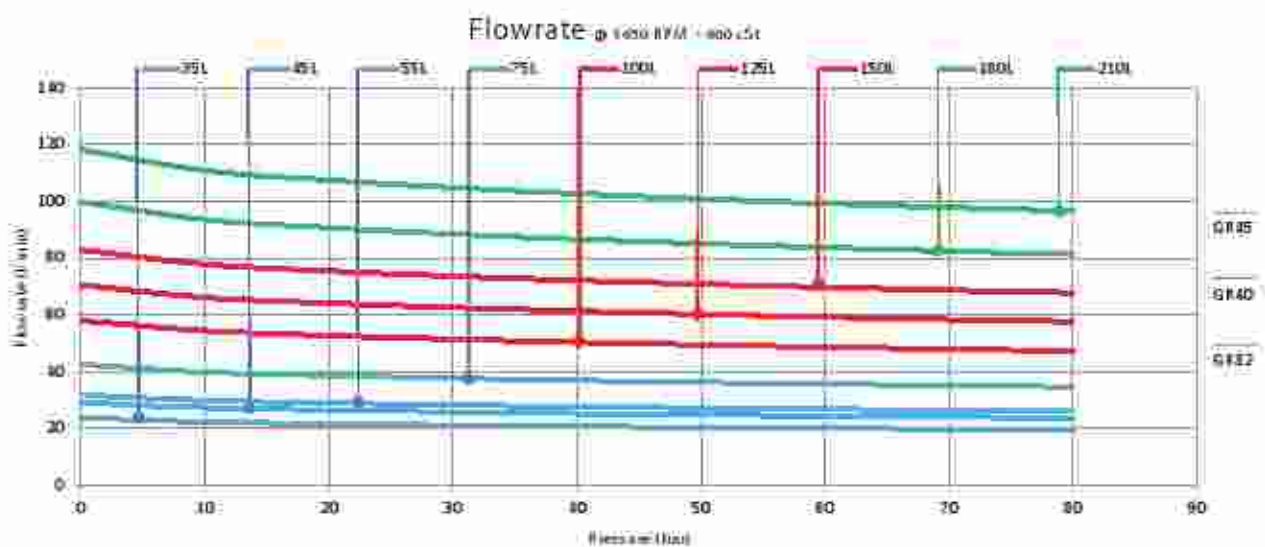
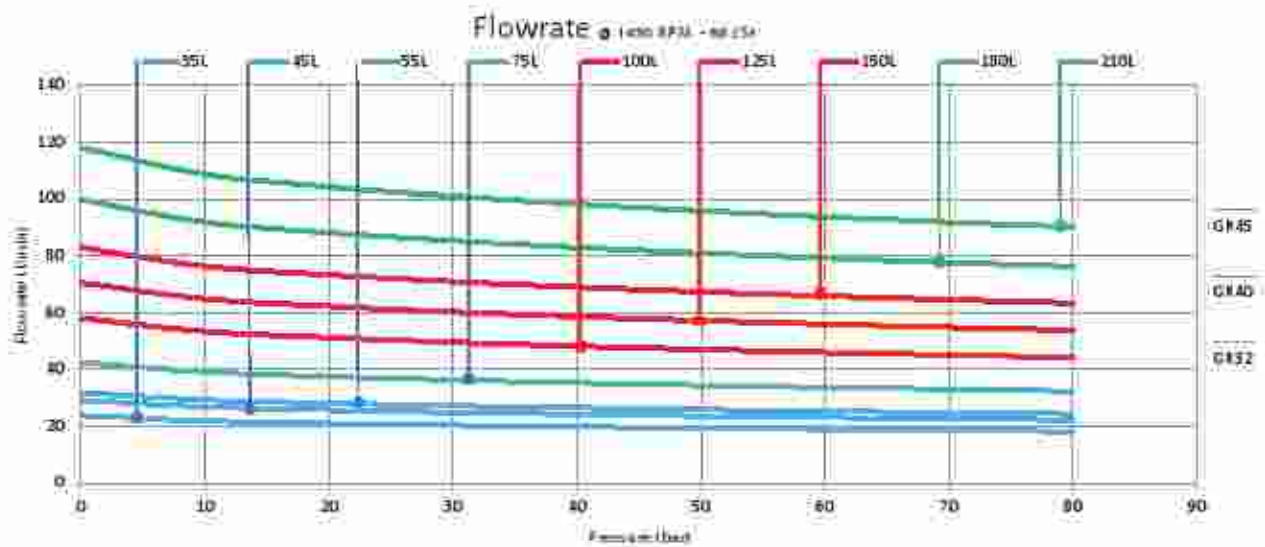
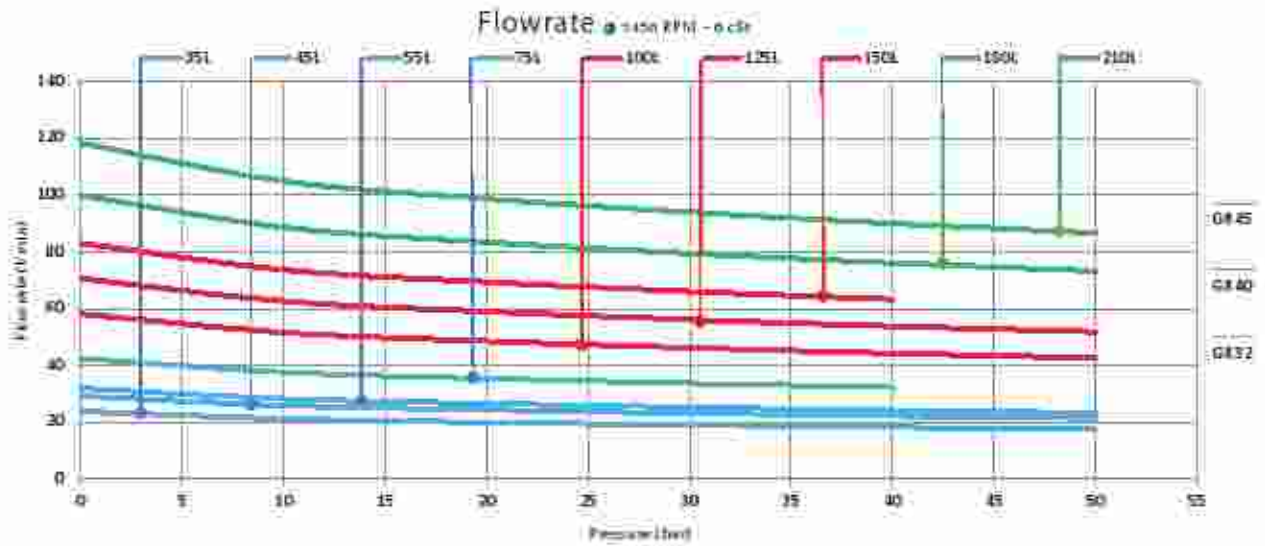

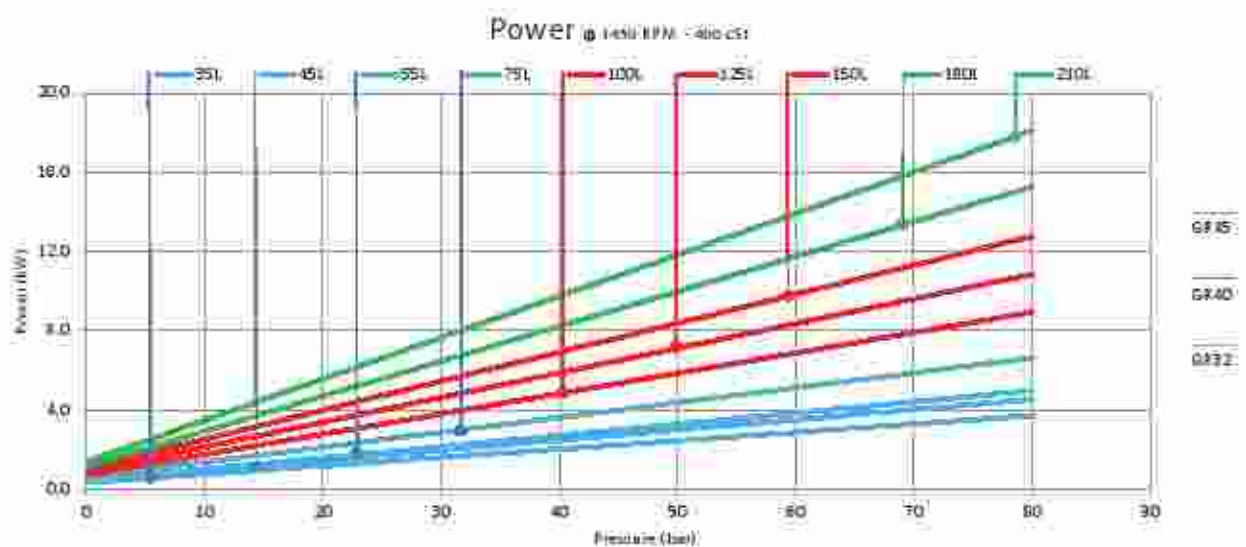
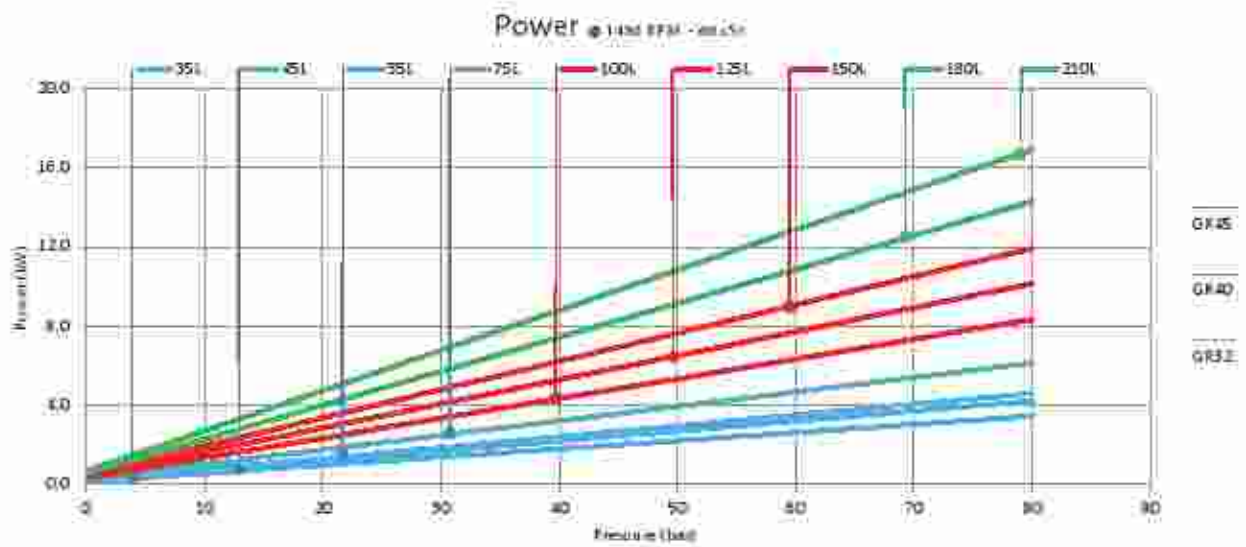
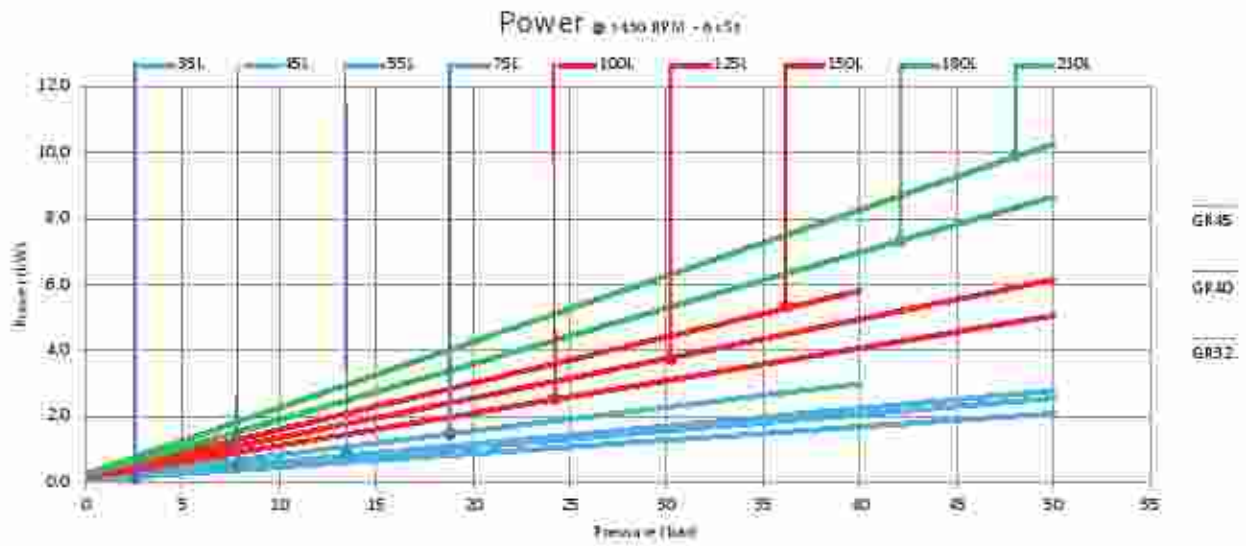

# Performances @ 3000 - GR 32-40-45

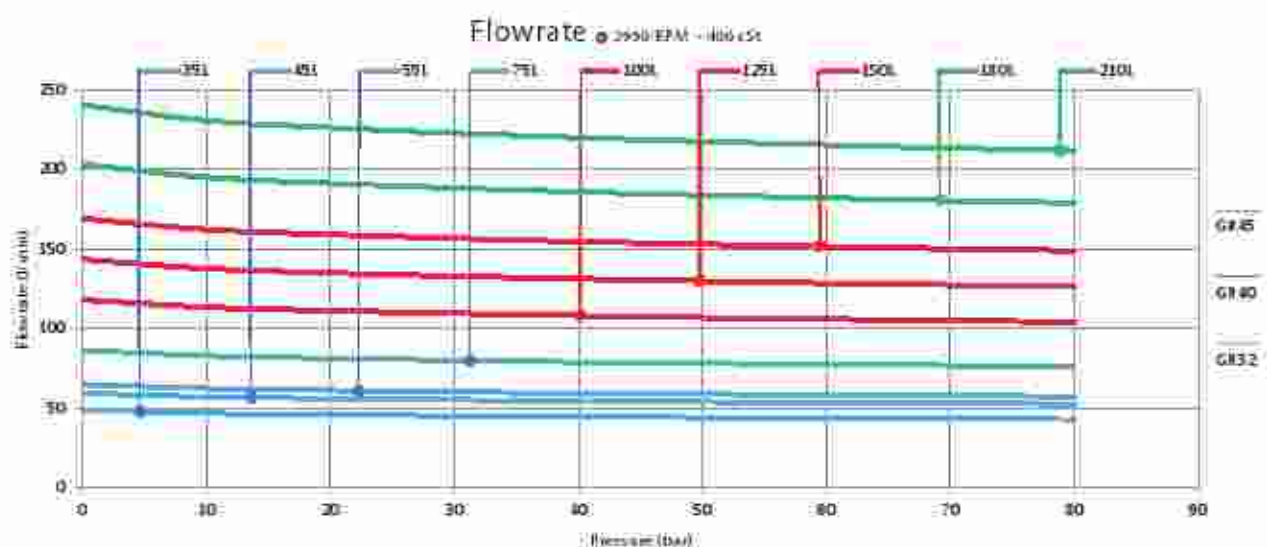
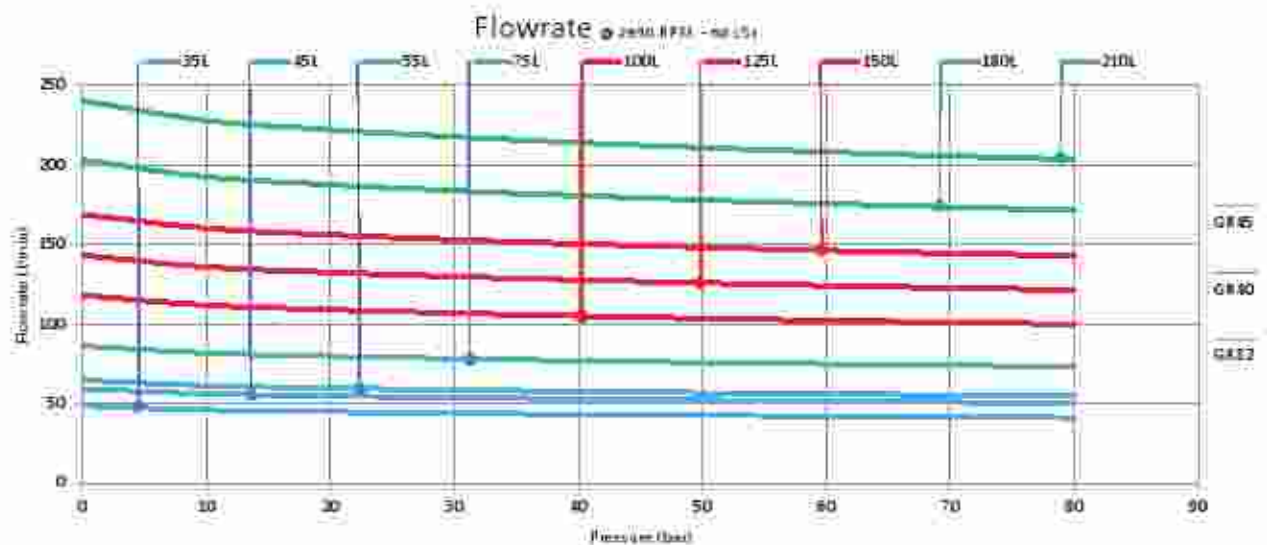
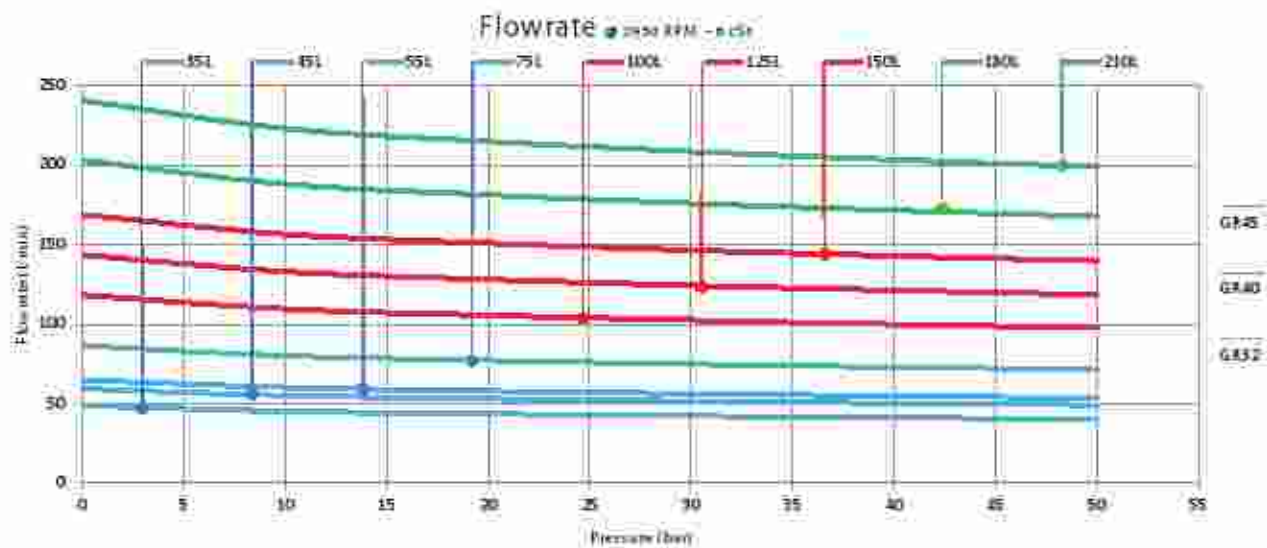

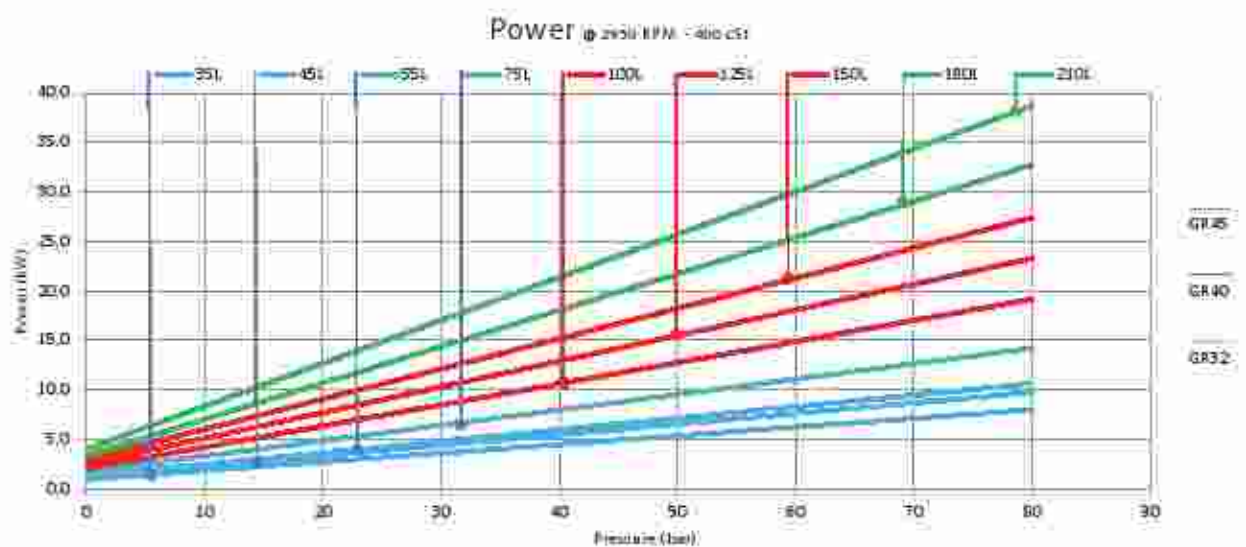
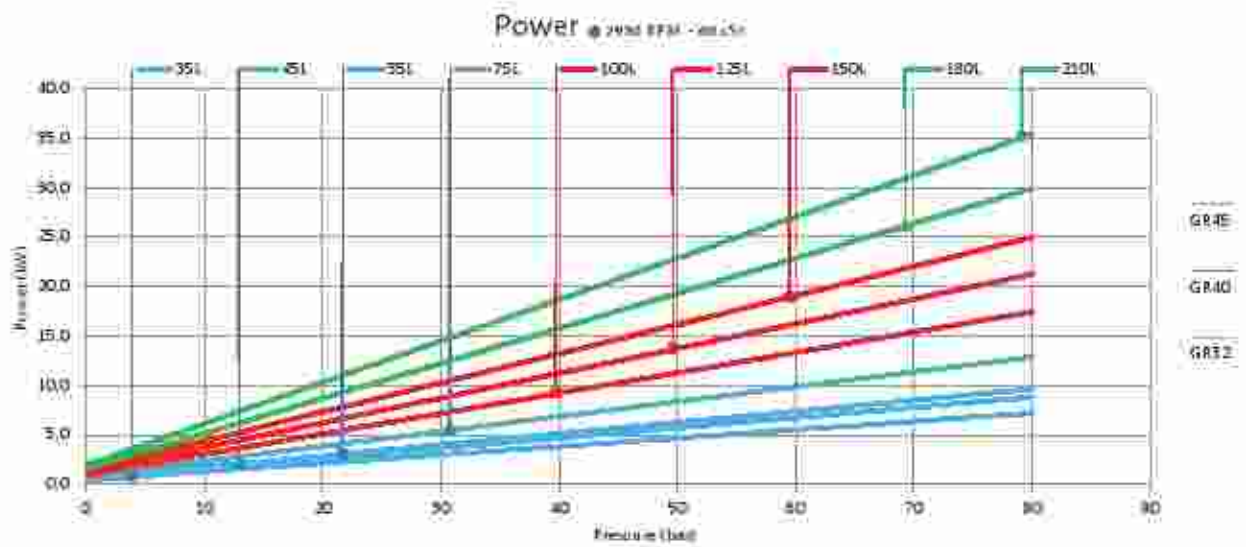
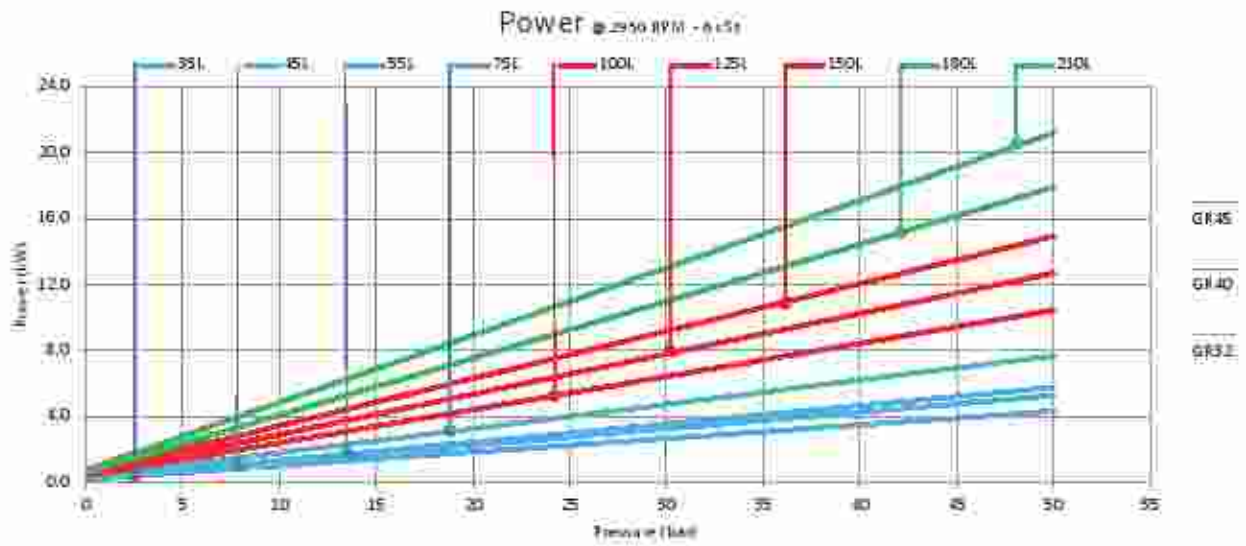

# Performances @ 1500 - GR 55-60-70-80-90

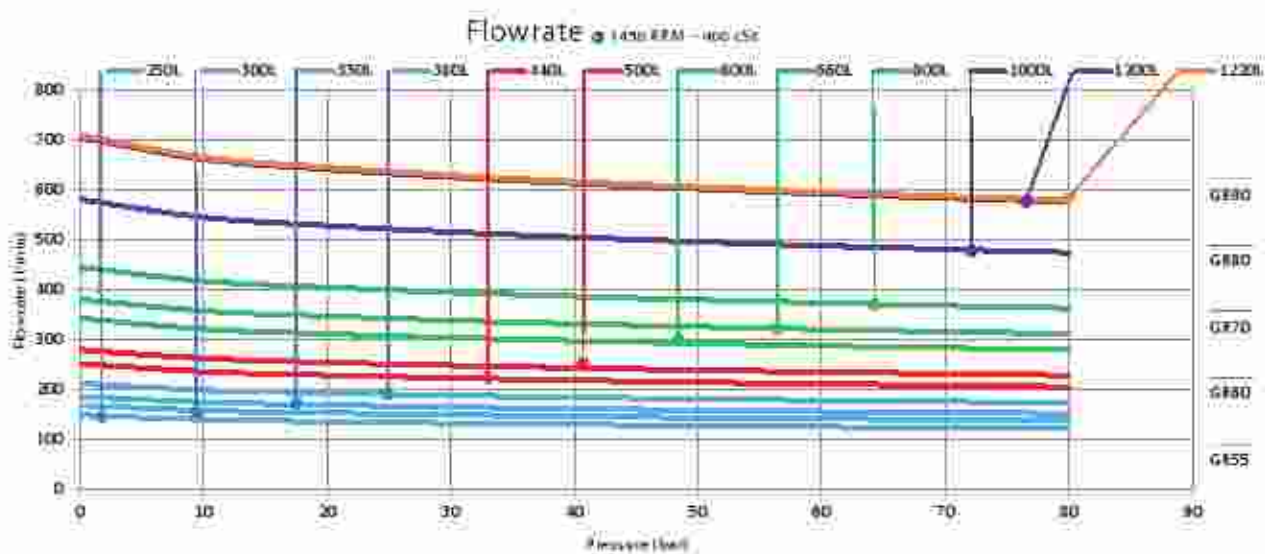
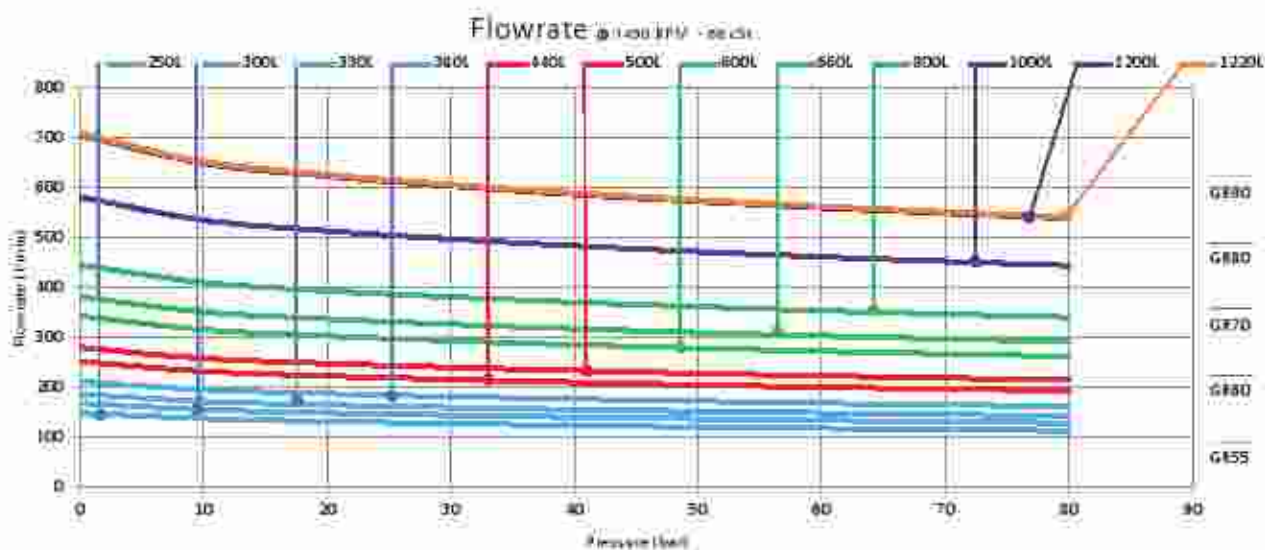
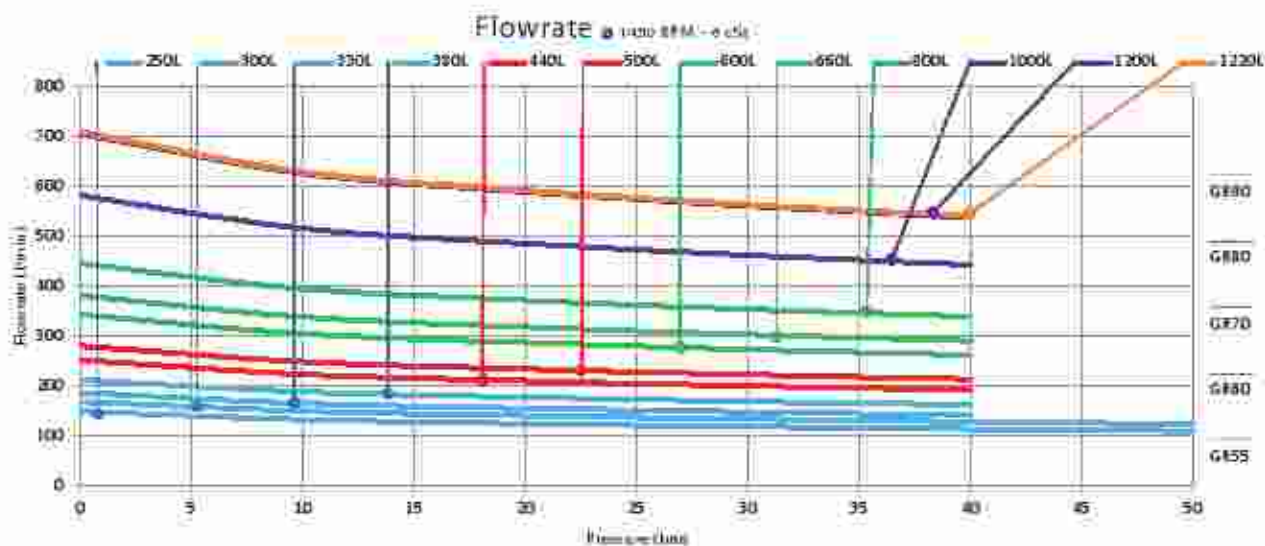



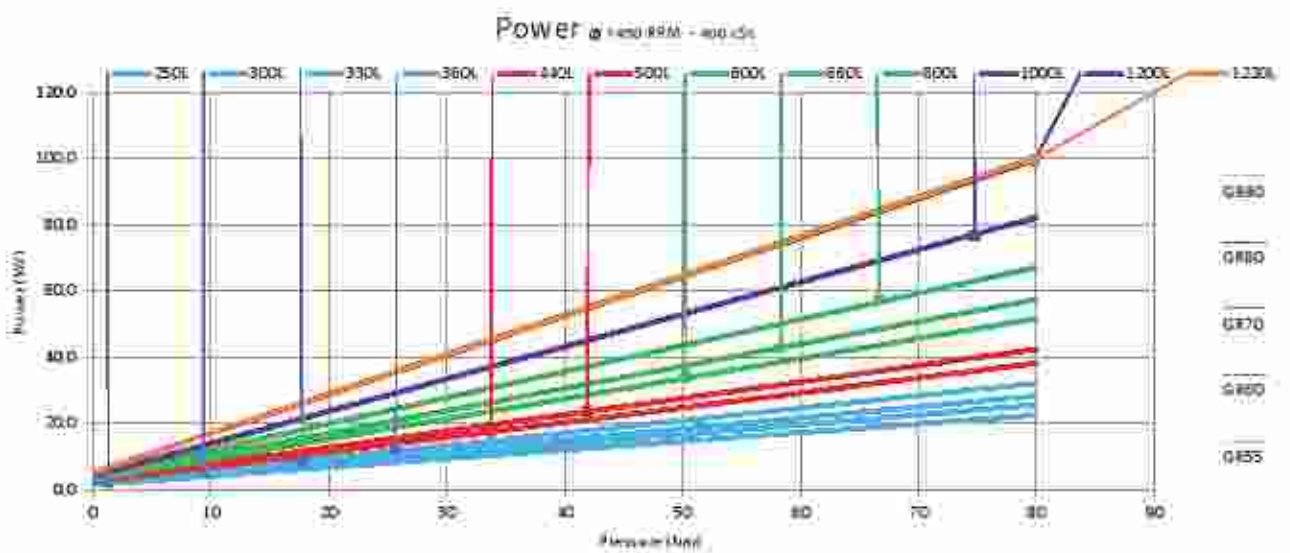
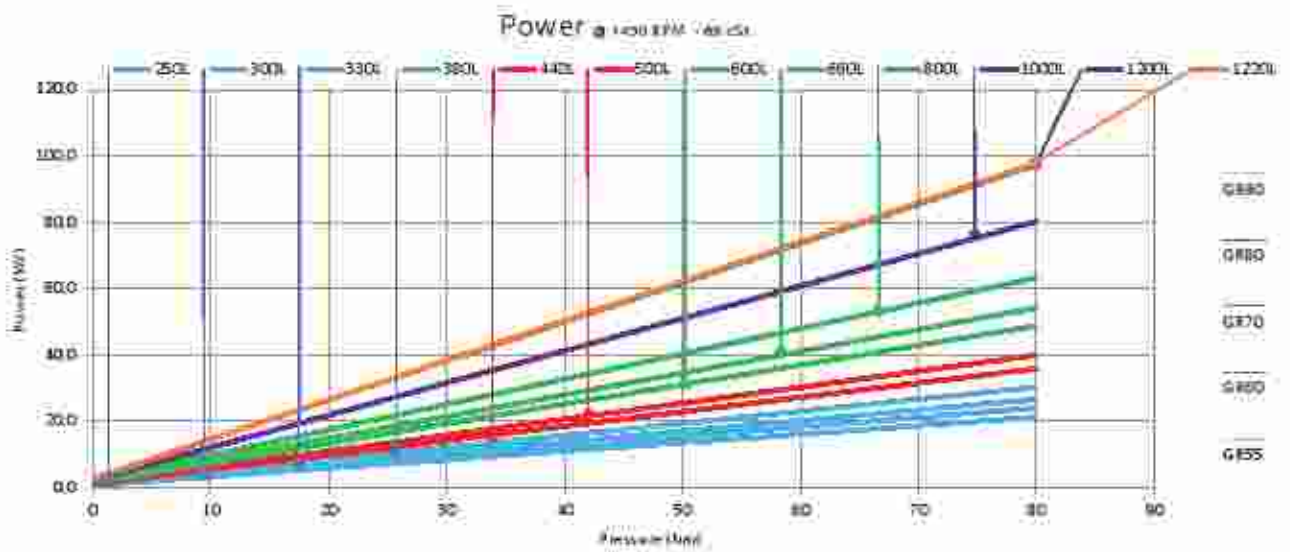
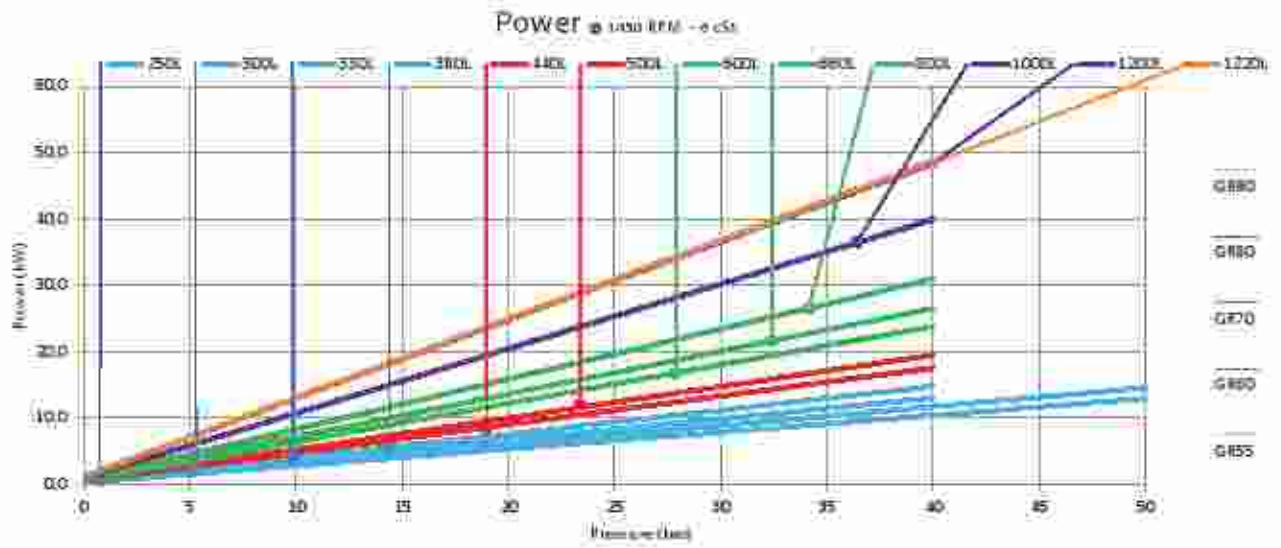

# Performances @ 3000 - GR 55-60-70-80-90

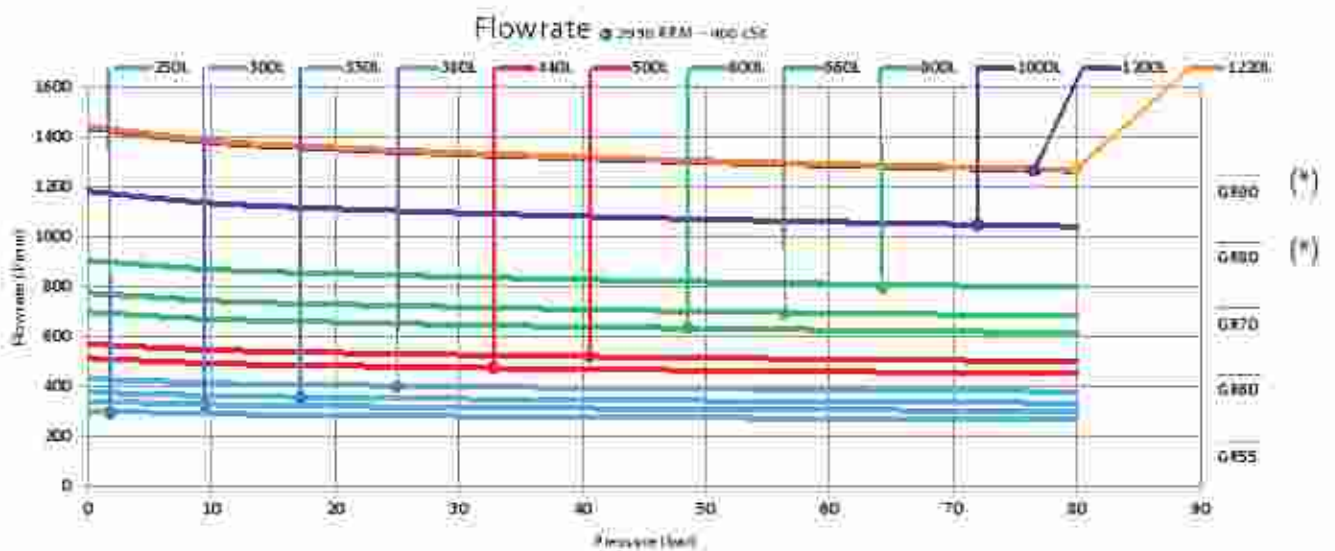
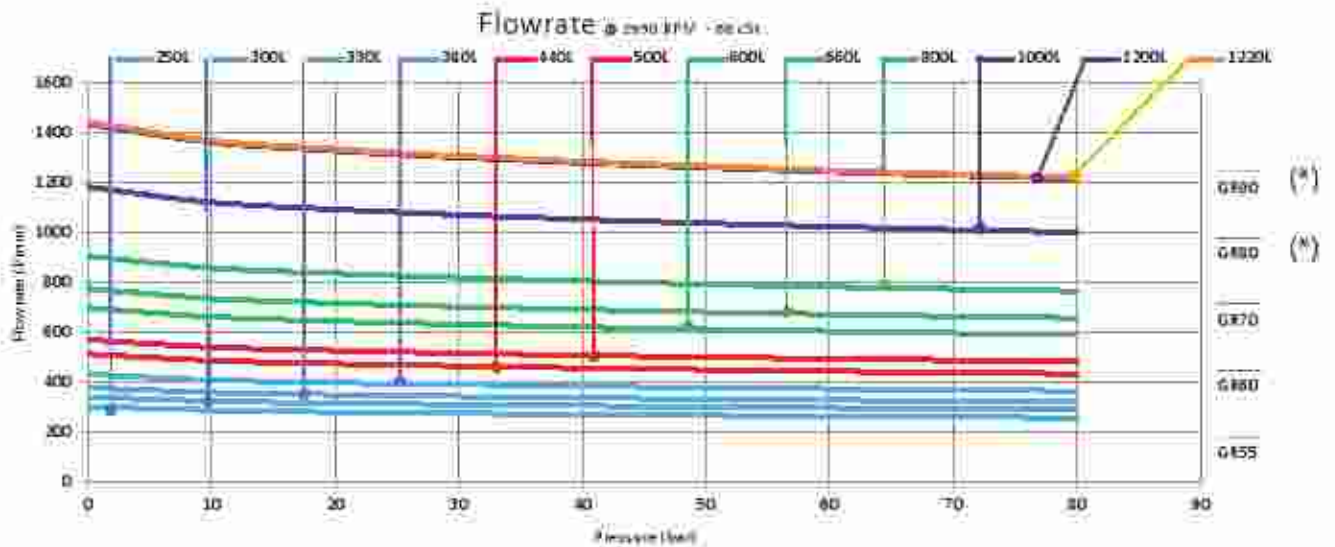
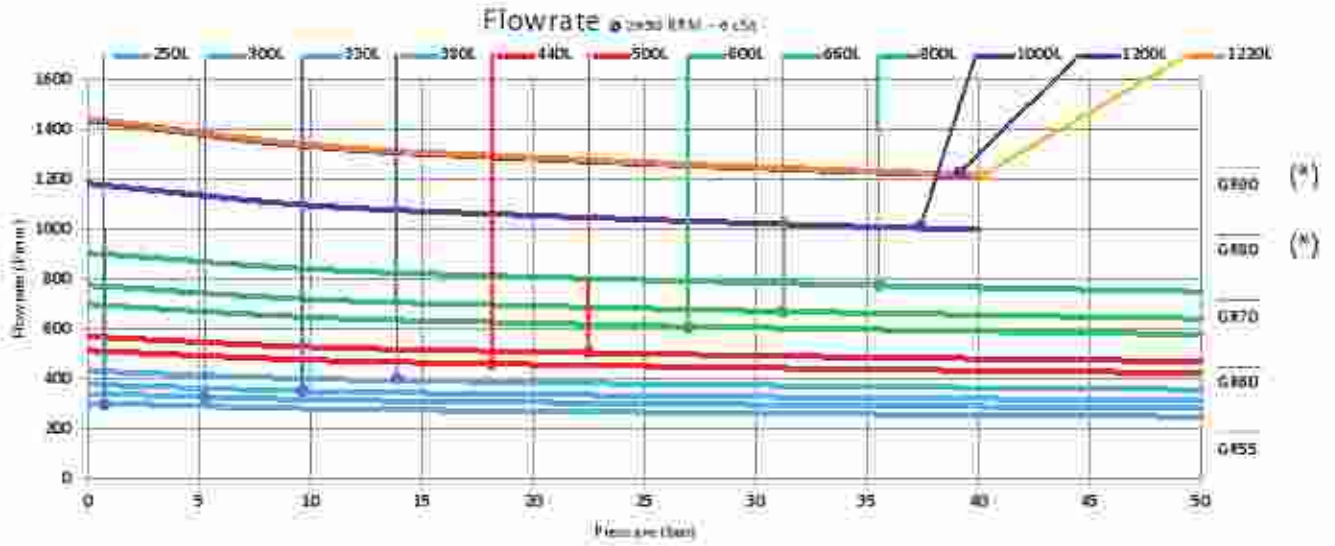

(\*) For shaft speed lower than 1.000 rpm and over 1.800 rpm please contact Settima. Per velocità inferiori a 1.000 rpm e maggiori di 1.800 rpm contattare Settima.

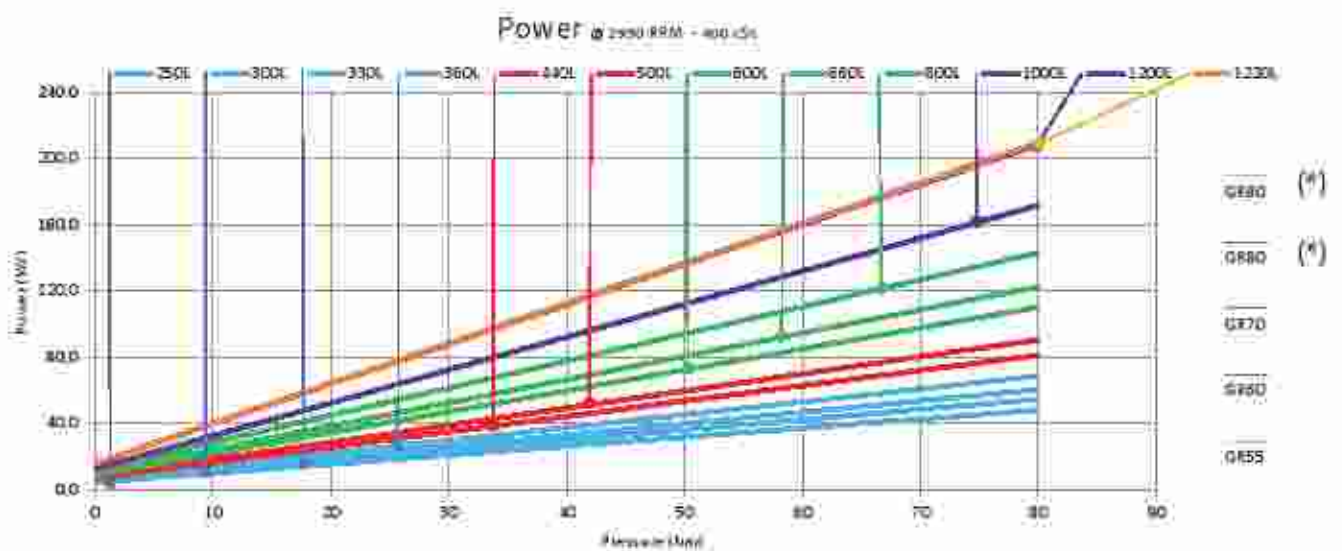
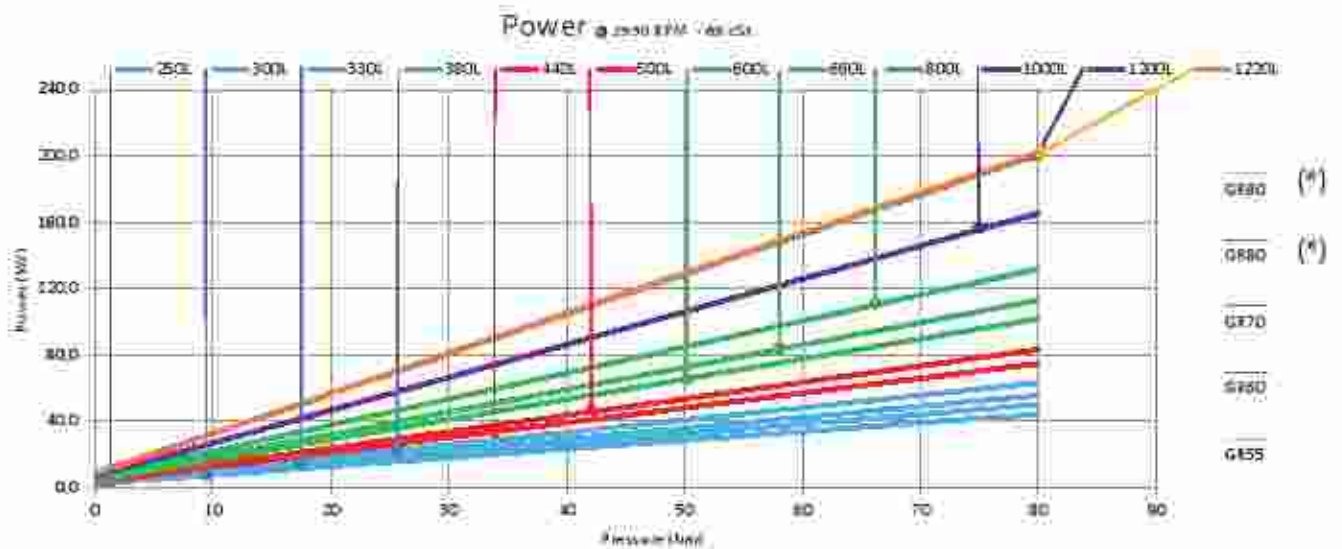
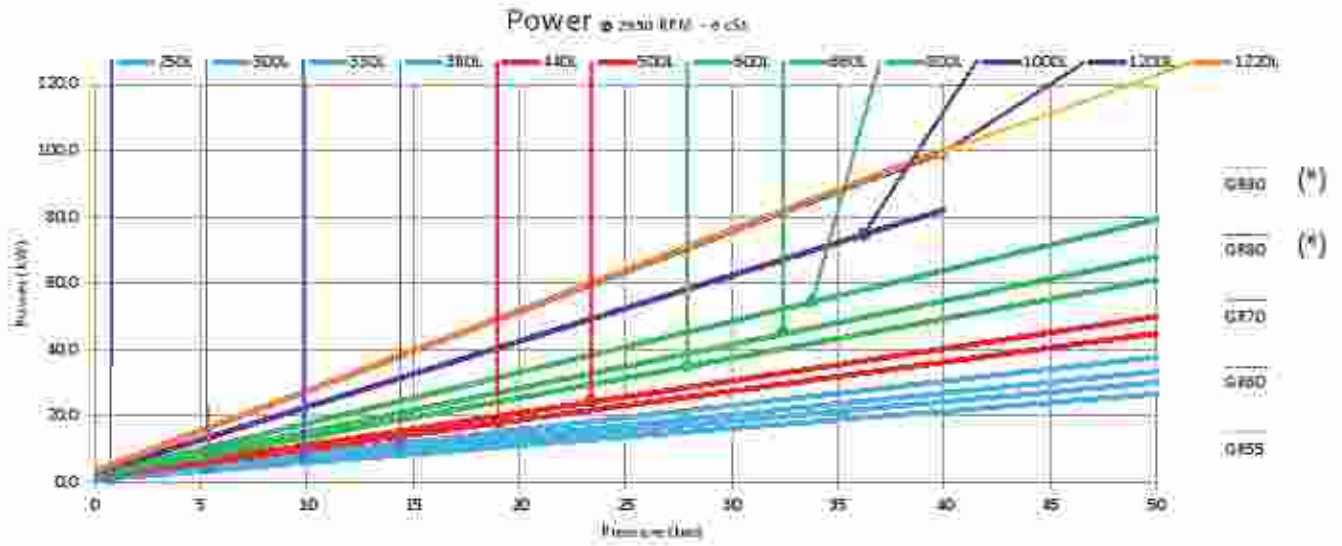

(\*) For shaft speed lower than 1.000 rpm and over 1.800 rpm please contact Settima. Per velocità inferiori di 1.000 rpm e maggiori di 1.800 rpm contattare Settima.

All data reported in catalogue can change without any notice.



I dati presenti nel catalogo possono cambiare senza preavviso.

**SETTIMA**

**Settima, Italy**  
Headquarter, r&d and production

**SETTIMA**

**USA**  
Warehouse

**SETTIMA**

**Shanghai, China**  
Warehouse

**Settima Meccanica Srl**  
Settima - 29020 Piacenza (Italia)  
tel. +39 0523 557623  
fax +39 0523 557256  
[www.settima.it](http://www.settima.it)  
[info@settima.it](mailto:info@settima.it)

**Settima Flow Mechanisms**  
Settima - 29020 Piacenza (Italia)  
tel. +39 0523 557623  
fax +39 0523 557256  
[www.settima.it](http://www.settima.it)  
[info@settimafm.com](mailto:info@settimafm.com)

 **SETTIMA MECCANICA**

Area Agency/Reseller

**SETTIMA**  
*flow mechanisms*